

Track Chart

Pennsylvania Railroad

Eastern Region

Phila. Terminal Division

Main Line and Branches

Scale: One Inch - One Mile

Philadelphia, Pa.

Correct To Jan. 1-1955



~ ↑ Legend ↓ ~

| | | |
|---------------------------|-------|---------|
| Prgr. Sta. Brick | Frame | Shelter |
| " " " | " " " | " " " |
| Interlocking Tower | | |
| Block Station | | |
| Watch Box | | |
| Tool House | | |
| Telephone Booth or Box | | |
| Ash Pit | | |
| Public Road X-ing (Grade) | | |
| Private Road X-ing | | |
| Overhead Bridge | | |
| Gridder | | |
| Slab | | |
| Arch | | |
| Signal | | |
| Tunnel | | |
| Dragging Equip. Detector | | |
| Water Station | | |
| Water Tank | | |
| Water Plug | | |
| Track Pan | | |
| Yard Limit | | |
| State, Co., Twp. Line | | |

| | |
|---------------------------------|--------------|
| Rail Section | Color |
| 155 Lbs. Solid Red | Red |
| 152 " " Solid Purple | Purple |
| 140 " " Solid Black | Black |
| 133 " " Solid Brown | Brown |
| 131 " " Solid Green | Green |
| 130 " " Solid White | White |
| 127 " " Dashed Brown | Brown |
| 125 " " Dashed Yellow | Yellow |
| 112 " " Solid Green | Green |
| 100 " " Solid Yellow | Yellow |
| 85 " " Dashed Red | Red |
| Less than 85 Lbs. Solid Black | Black |
| 24 Ties to 39' Rail-underscored | Red |
| Signalled in both directions | Red |

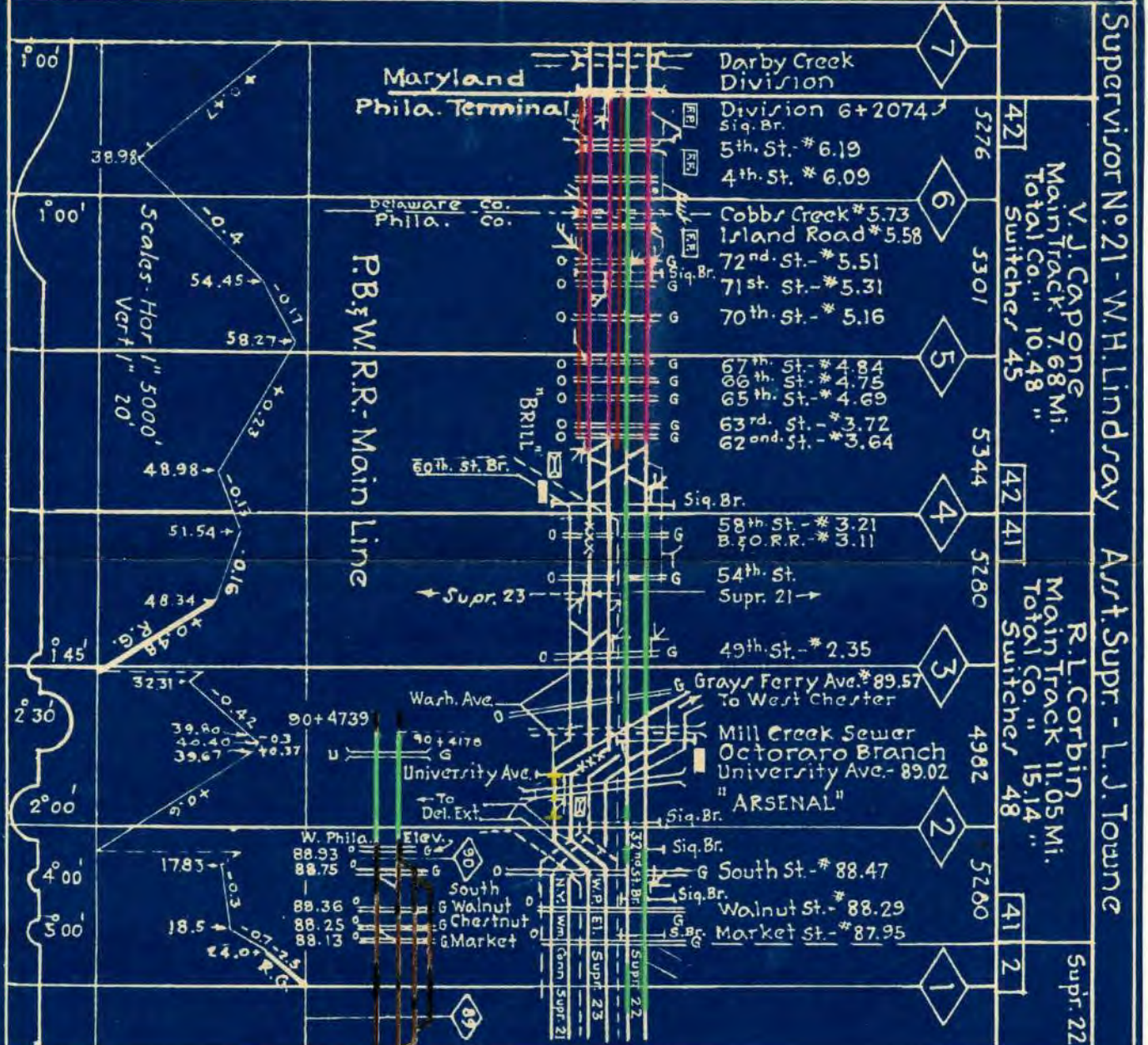

Supervisor No. 21 - W. H. Lindray
Main Line - Girard Ave. To Liddonfield
Arst. Supr.

| | | | | |
|--|---|---|---|---|
| J.J. Connolly, Jr. Main Trk. 6.0 Mi. Total Co. 9.1" Swr. 75 | J.J. Connolly, Sr. Main Trk. 6.9 Mi. Total Co. 12.2" Swr. 66 | F.J. Meccardiello Main Trk. 7.5 Mi. Total Co. 8.7" Swr. 55 | G. Pallante Main Trk. 17.6 Miles Total Co. 17.6" Switcher 34 | G. Grader Main Trk. 1 Total Co. 1 Switcher 1 |
|--|---|---|---|---|

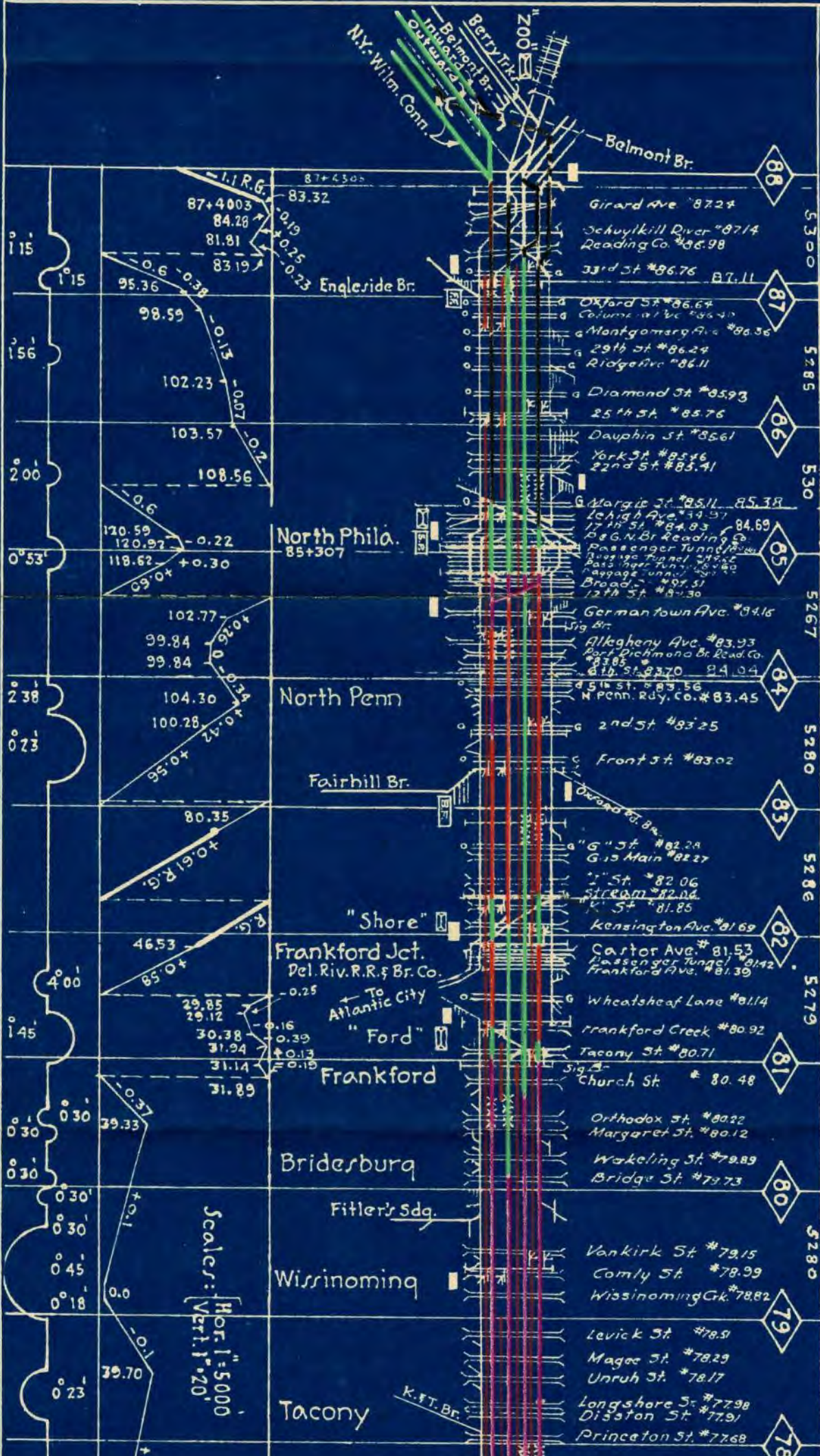

L.J. Towne

6.5 Miles
8

34

10

SCARPONE
MAIN TRACK 16.8 MILES
TOTAL CO. " 23.6 "

SUPERVISOR

No. 22

W. K. Mangum

C. TROILLO
MAIN TRACK 22.0 MILES
TOTAL CO. " 23.7 "

MAIN L

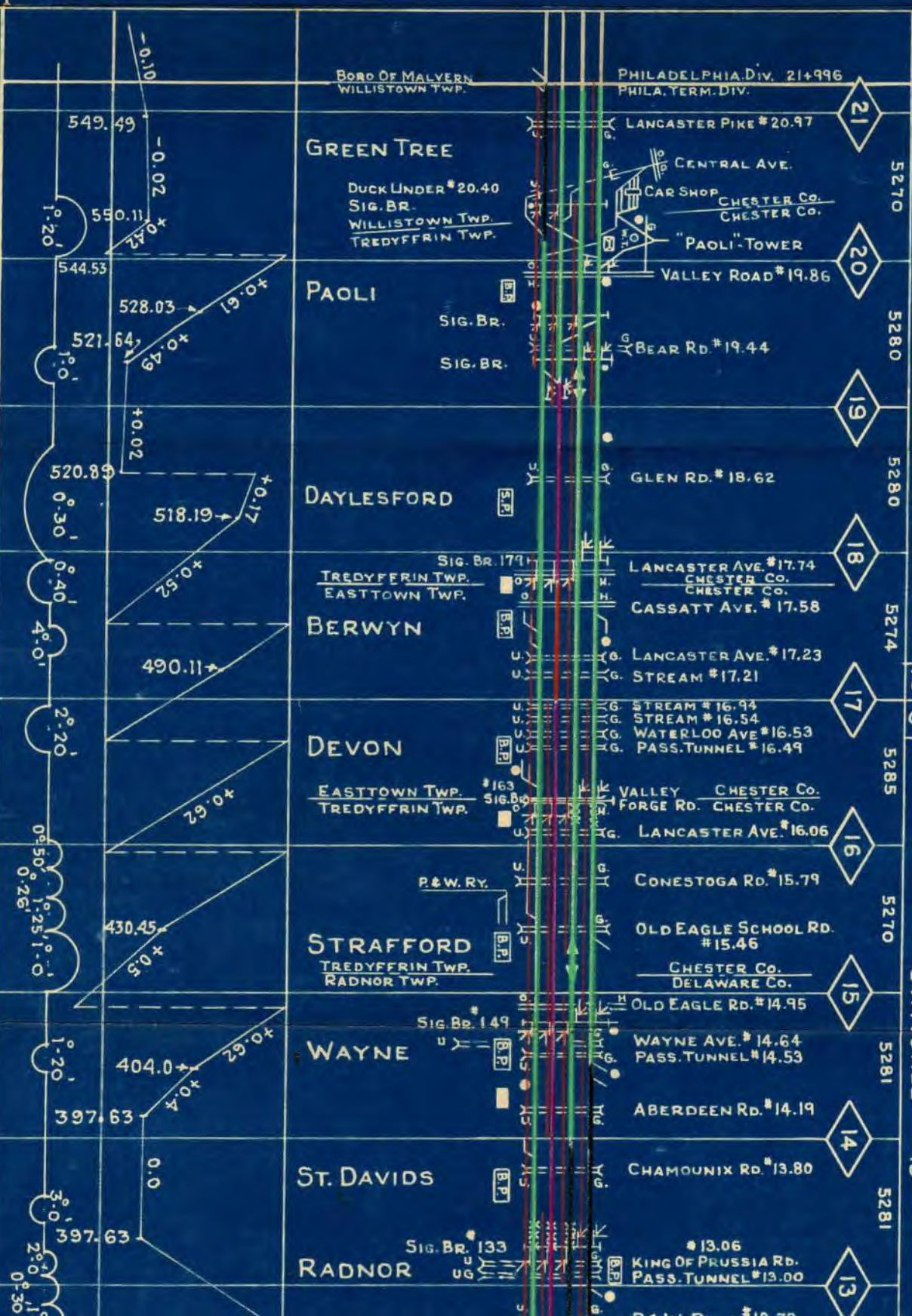
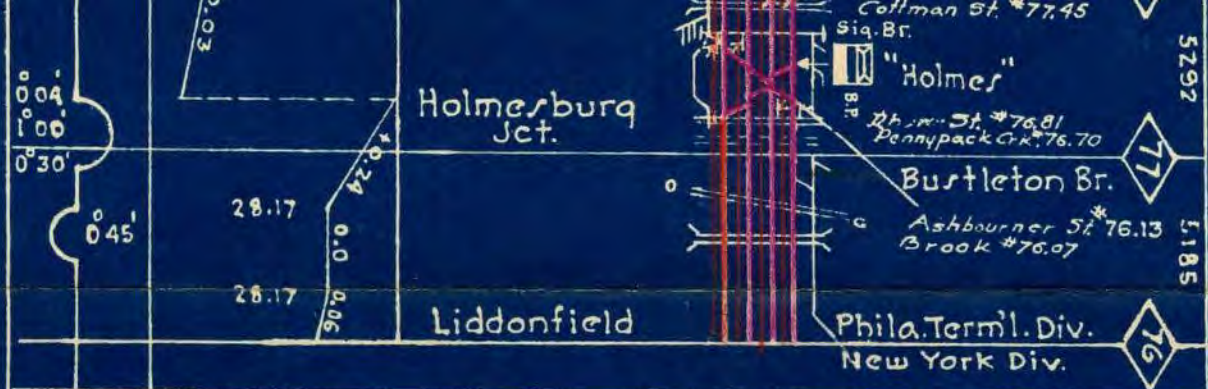

LINE - SUBURBAN STATION TO GREEN TREE

T. SULLIVAN
 MAIN TRK. 18.0 MILES
 TOTAL CO. " 20.7
 SWITCHES 39

M. SIRAYO
 MAIN TRK. 7.4 MI.
 TOTAL CO. " 12.83
 SWITCHES 38

D. MANENTI
 MAIN TRK. 10.66 MI.
 TOTAL CO. " 12.51
 SWITCHES 47

J. RAFFERTY
 M.T. 4.38
 T.CO. 6.20
 V.N.M. M.TRK. 1.45
 T.CO. " 5.57
 SWS 32

ASST. SUPR. G. E. ELLIS

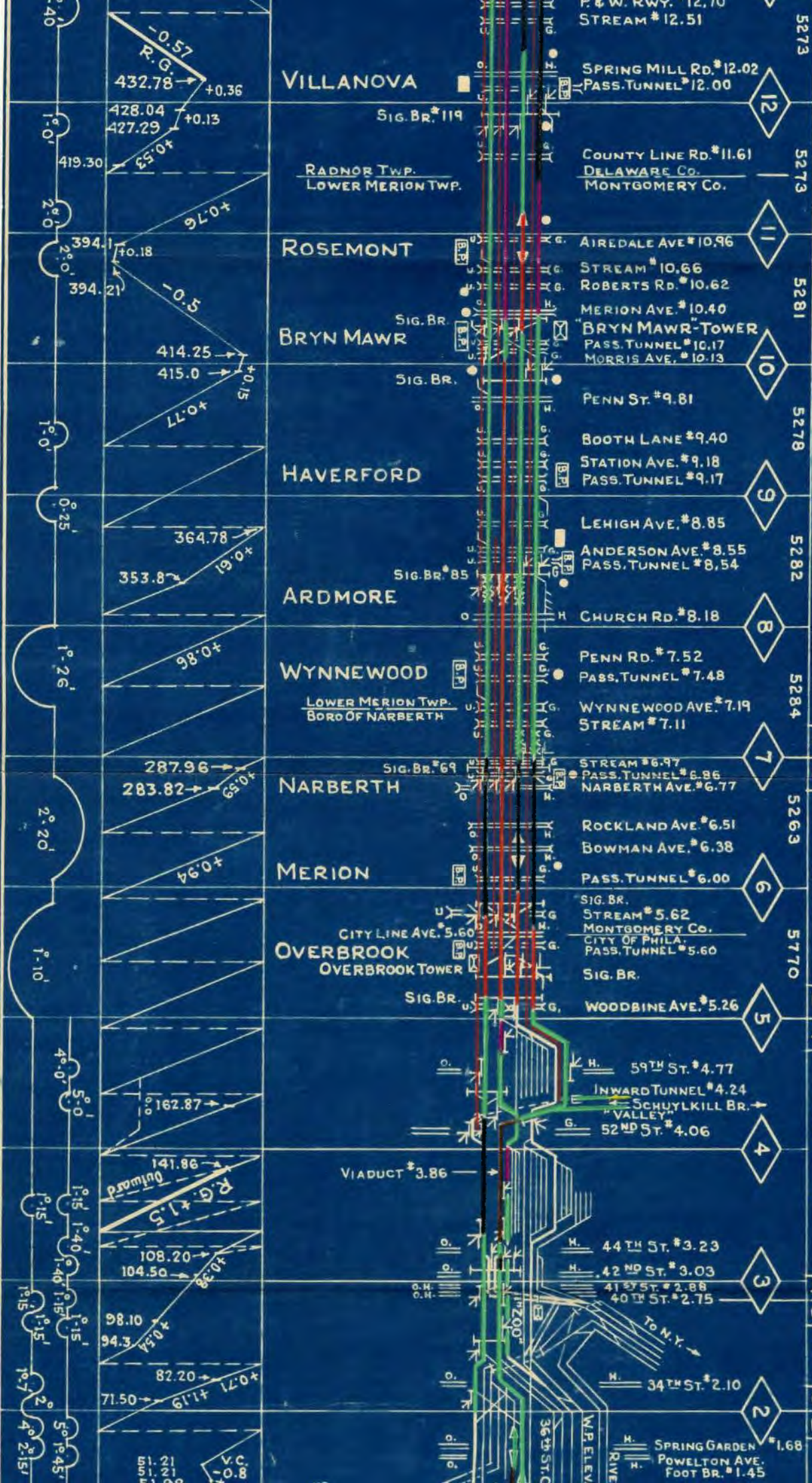

ANENTI
10.15 M.
11.47"
44 2 1 1 5.95 1

Supervisor No. 22
36th St. Connection
J. TRABASSO

Supr. No. 22
N.Y. PITTS. TUNNEL
J. RAFFERTY

Supr. N
M. Lindsay
F. Brindisi
Main Track - 5.61 Mi.
Total Co. 17.02"
Switches 103

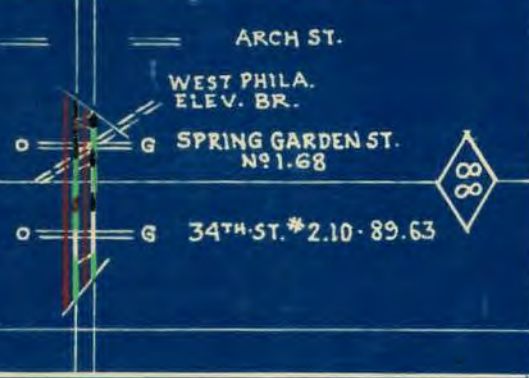
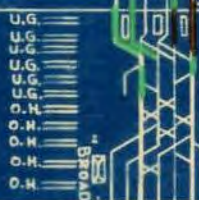

"North Philadelphia"



Branch Asst. Supr. - L. J. Towne

F. Pallante
Main Track - 13.63 Mi.
Total Co. 16.35
Switches 36



Supr. No. 2 H. Lindsay
Del. R.R. & Br. Co.

G. G. G. G.
Main Track - 8.52 Mi.
Total Co. - 10.52
Switches 27

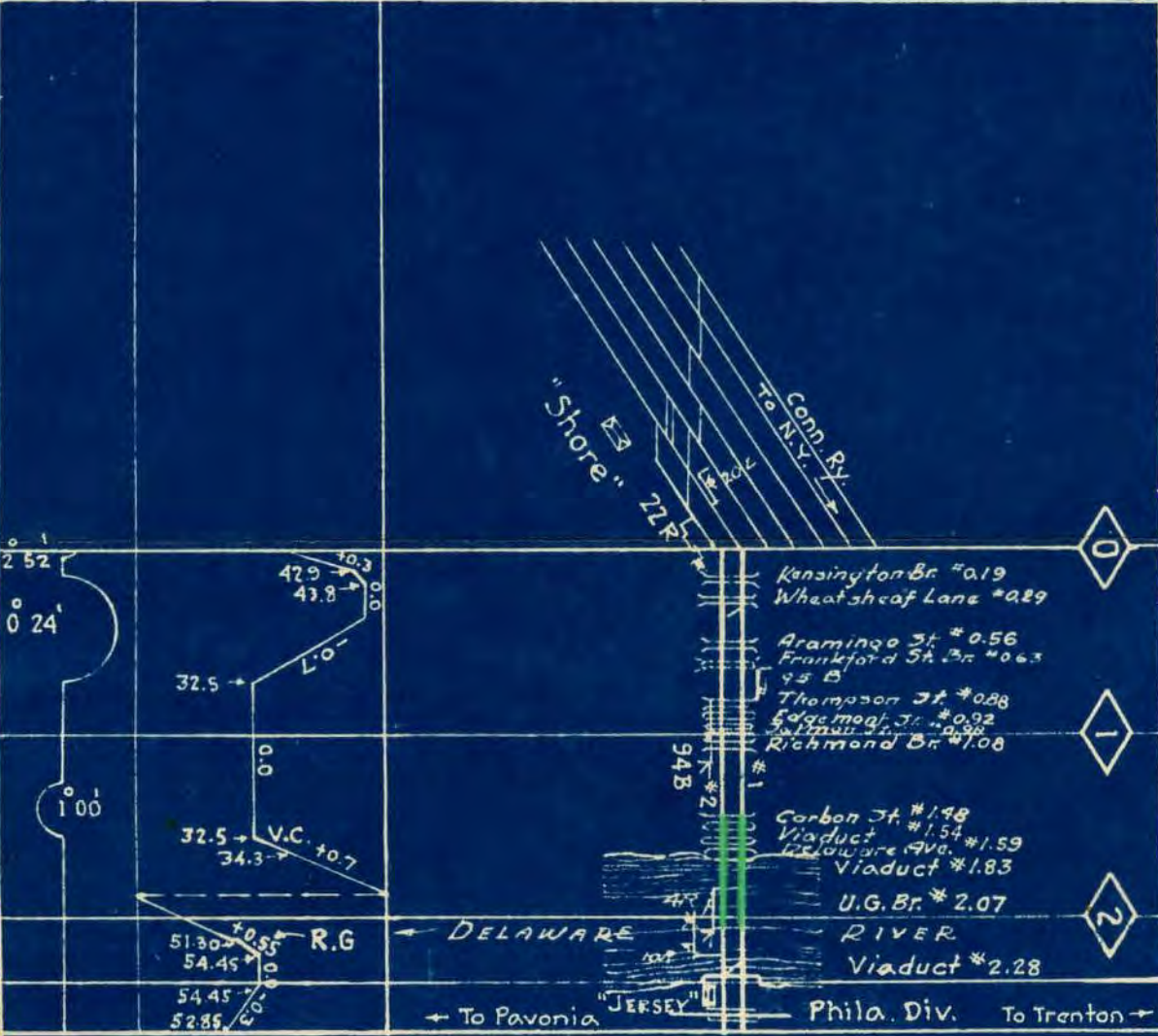

Supr. No. 21 - W.H.L.L.

35



G. VENEZIALE
 MAIN TRACK - 4.21 MILES
 TOTAL CO. " 5.63
 SWITCHES 17

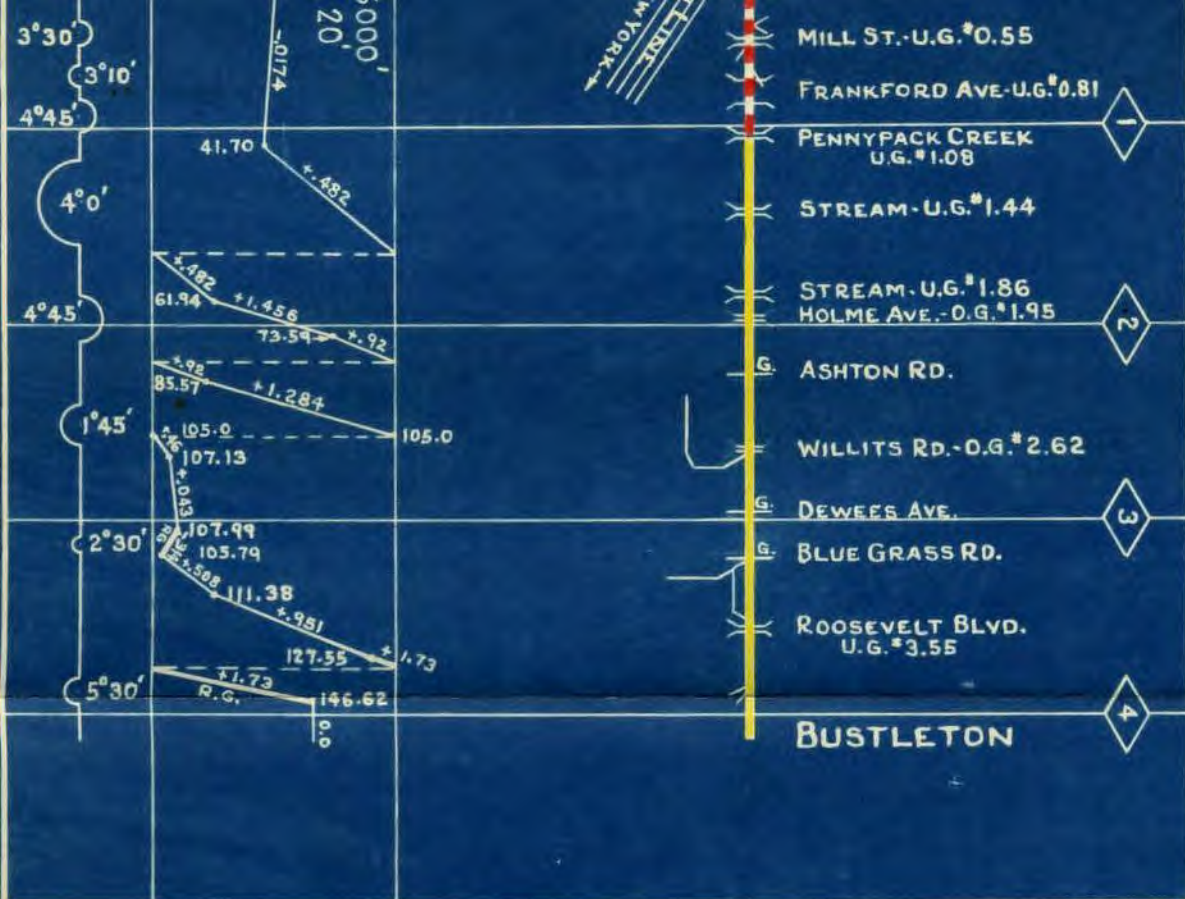

F. Pallante
 Main Track 6.23
 Total Co. " 7.82
 Switches 15

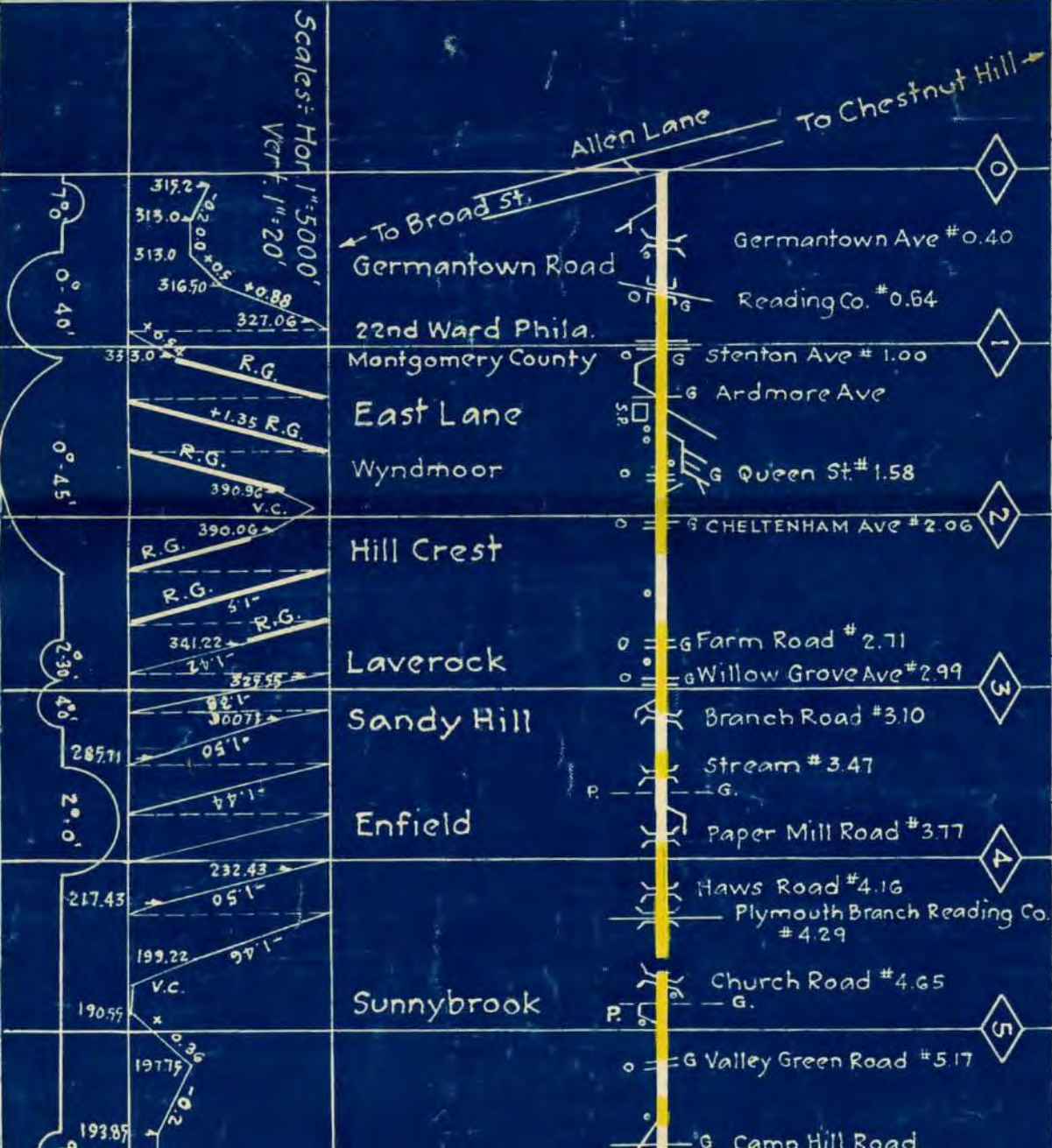

Scales: Hor 1"=5000'
 Vert 1"=20'

L. J. Towne

White Marsh
← To Trenton — Phila. Div. — To Glenloch →

Conn. Ry.
P.R.R.

H

Supr. N.E. 21 WILLI

S. L. Victoria
Fore.

OXFORD ROAD BRANCH Arit. S. L. J. Towne

37

G. F. F. J. Jr.
Main Track 3.61
Total Co. " 8.19
Switches 57

37

Scales: HOR.
Vert. 1" = 20'

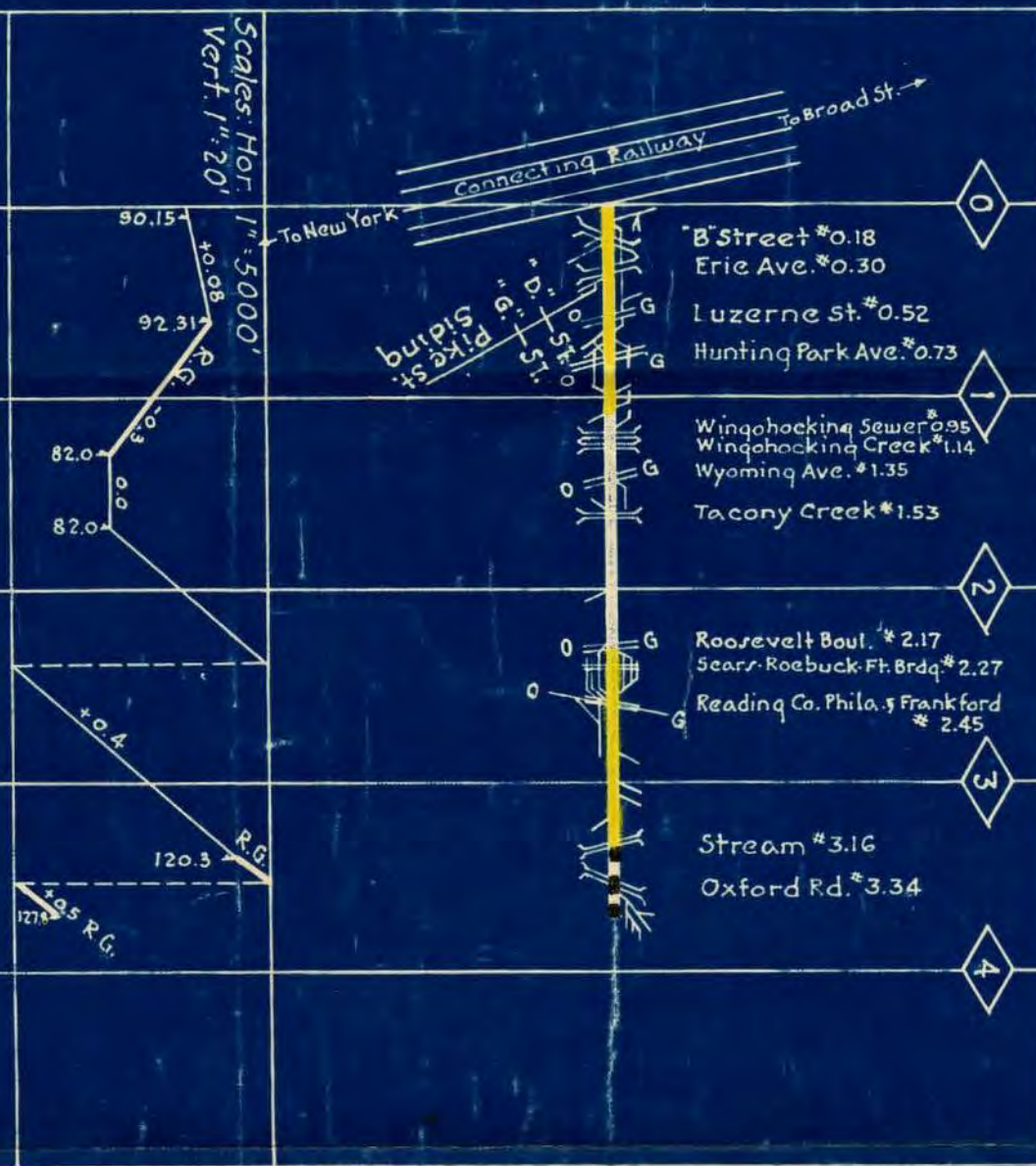

06

7785

4710

West Chester Branch
Superv
F. Pitti
Main Track

Jr. West Chester Br., Phila. Div.

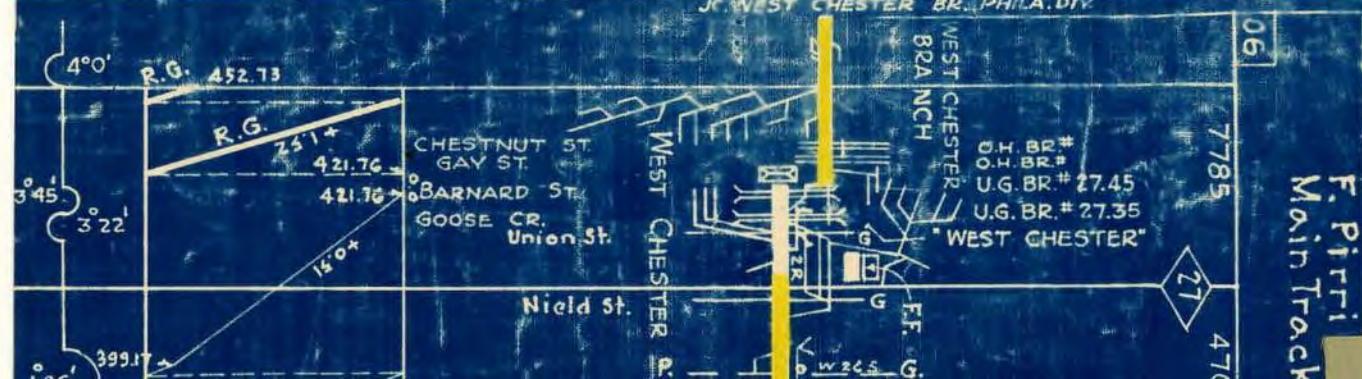

No 21 W.H. Lindsay
 WAWA BR.
 ASST. SUPERVISOR L.J. TO

6.79 Total Co. 11.80
 Switches 42
 West Chester Pa.
 W.A. Thum
 Main Track 8.22 Total Co. 12.33
 Switches 48 To M.P. 15 - See 25878

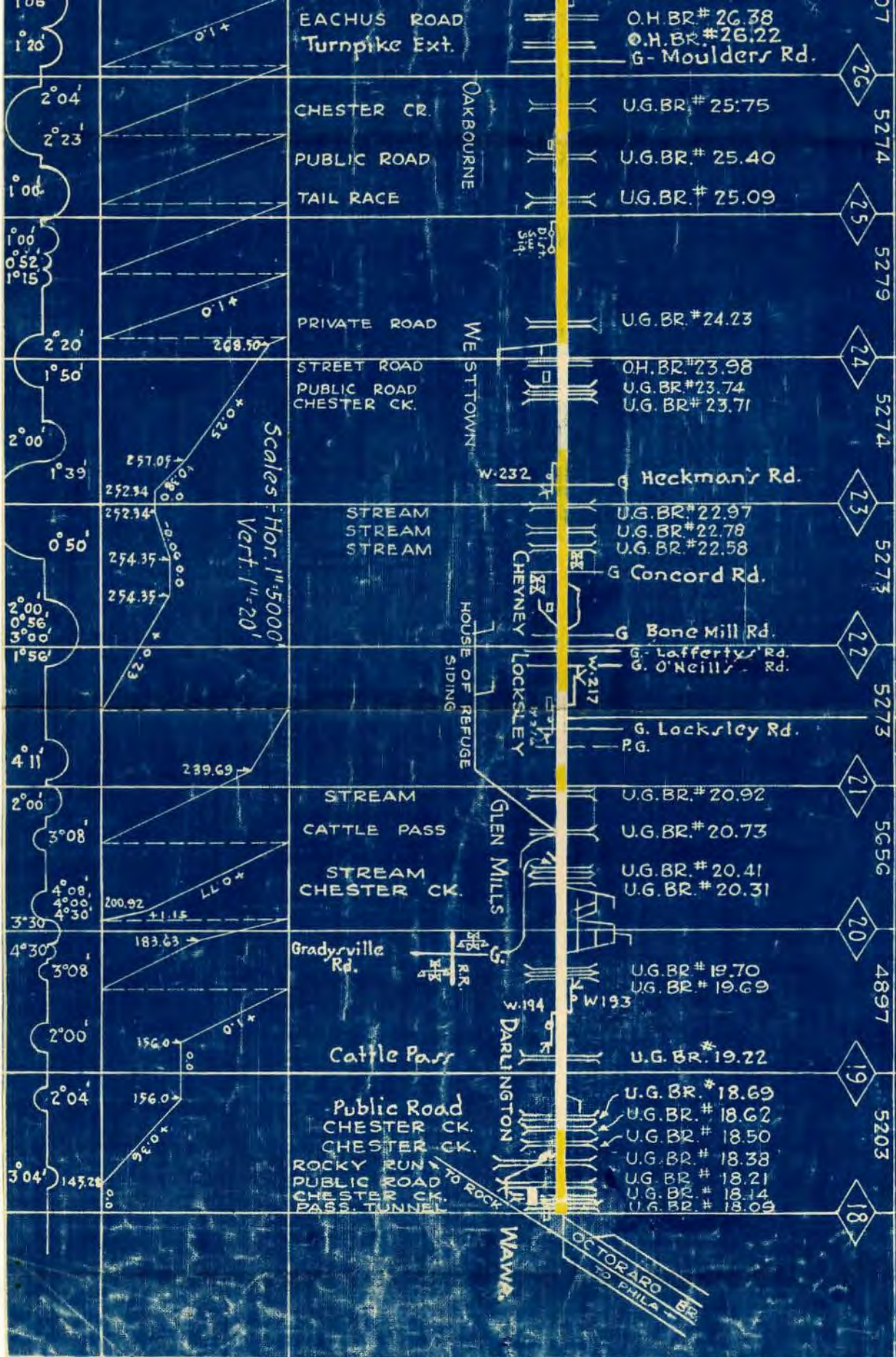

W.A. Thum
Wawa Pa.

N. Poter
Media Pa.

M. Della camera
Morton Pa.

AS

W.A. Thum
Main Track 8.22 Total Co. 12.33
Switcher 48

N. Poter
Main Track 8.00 Total Co. 9.58
Switcher 26

M. Della camera
Main Track 8.00 Total Co. 9.22
Switcher 18

AS

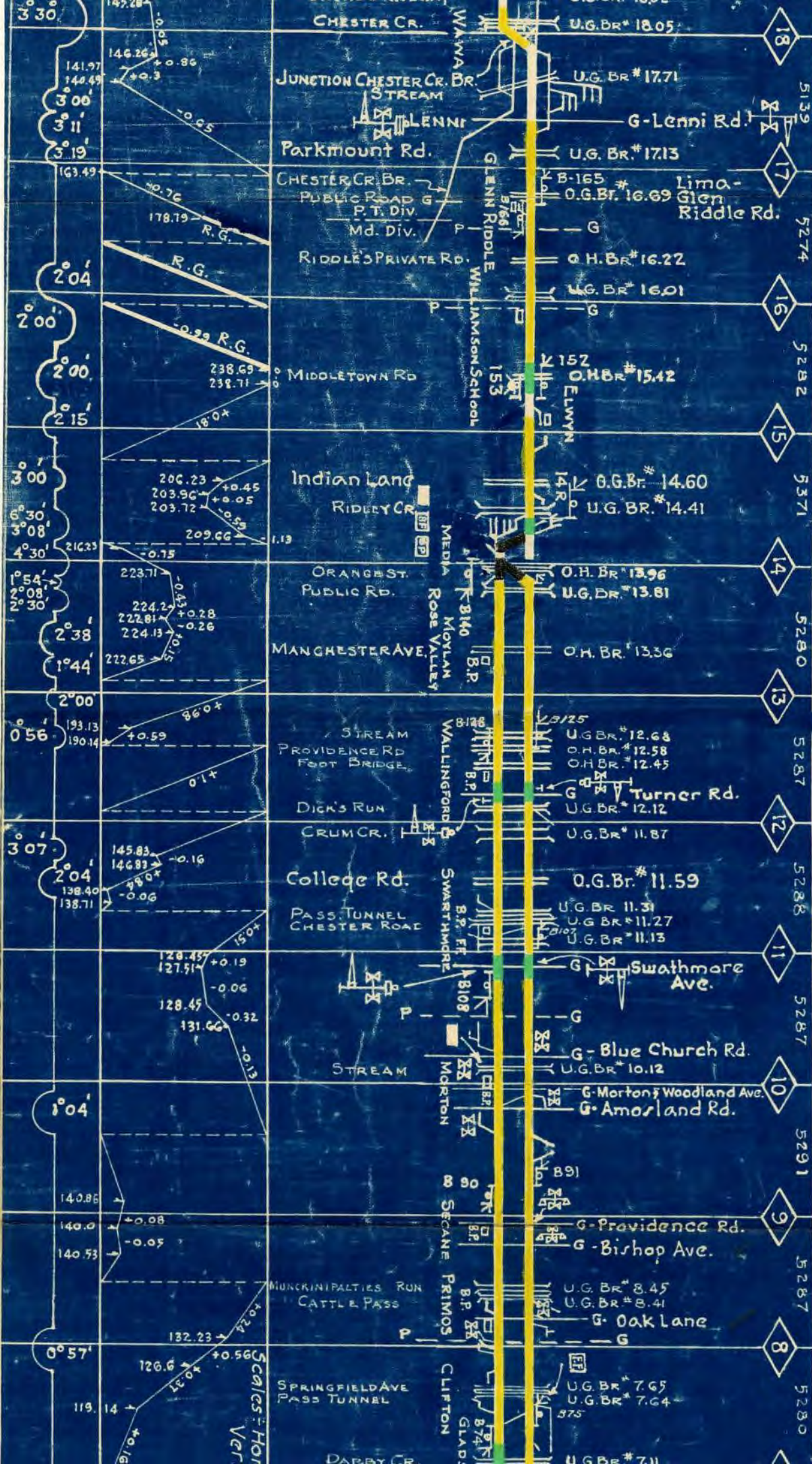

ST. SUPERVISOR L.J. TOWNE

F. Palma
MAIN TRACK 9.46
SWITCHES 49
FERNWOOD PA
TOTAL CO 13.71

M.T. 1.12
SWITCHES 5
FORG.

R.L. Corbin

SUP'R 21 CARDING
J. DUGAN
MAIN TRACK 2.27
SWITCHES 15
FERNWOOD PA
TOTAL CO 3.95
BRANCH ASST 5.21

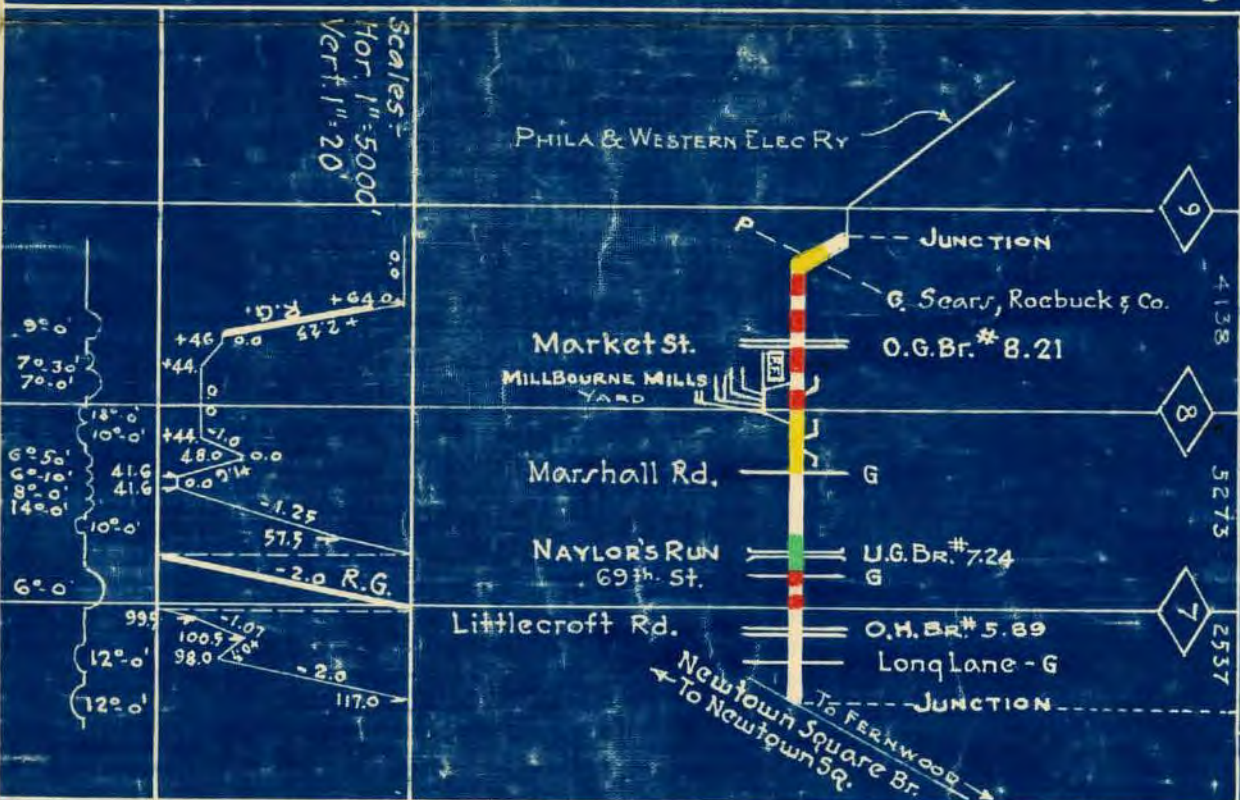
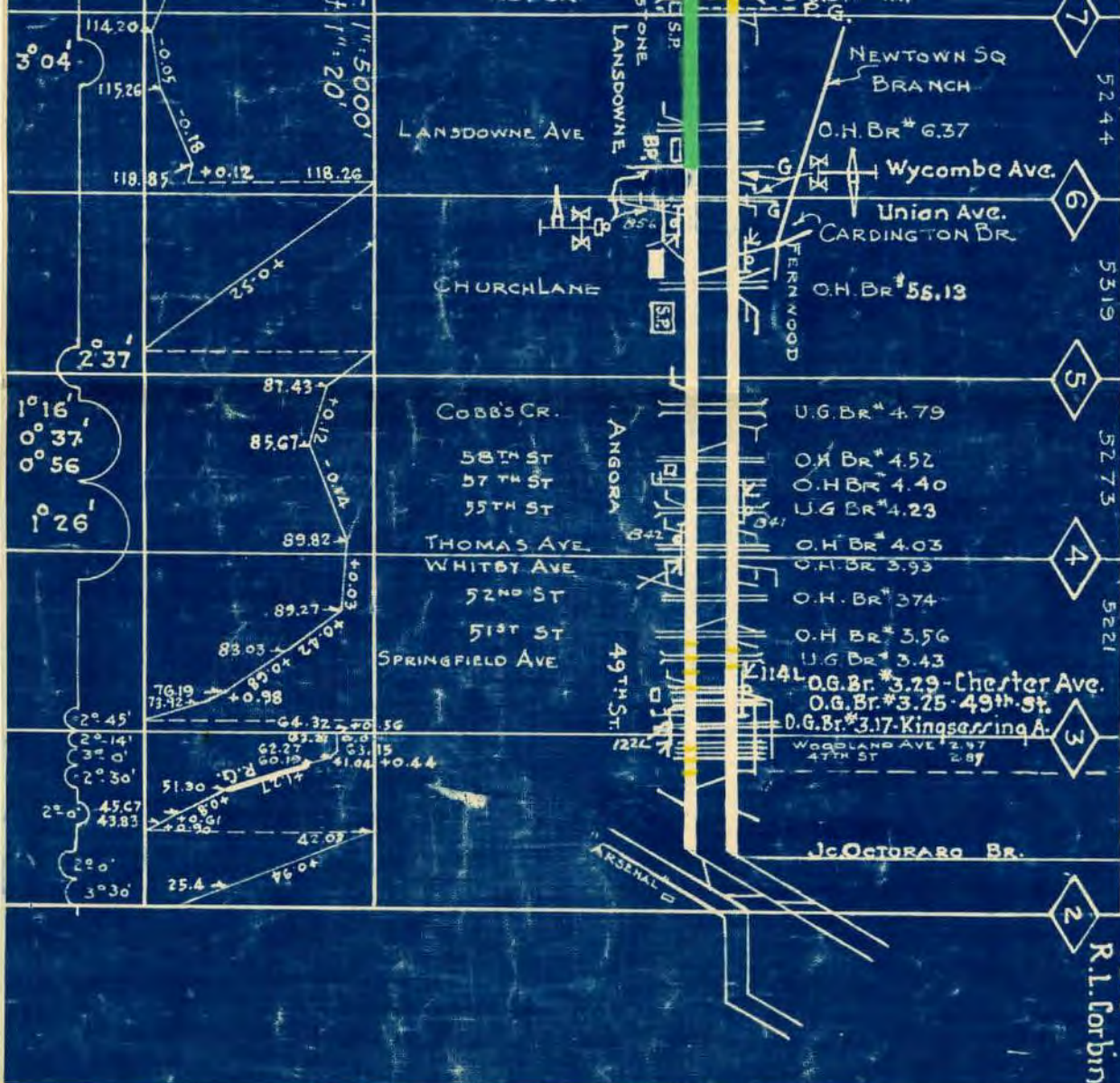

SUPERVISOR No 21 W.H. Lindsay NE
 J. DUGA
 FERNWOOD PA
 L.J. TOWNE

222
 2985
 5375
 5279
 5282
 5274
 5278
 5282
 5278
 5274
 5281
 022.02

MAIN TRACK 985
 SWITCHES 54
 TOTAL CO 13.51

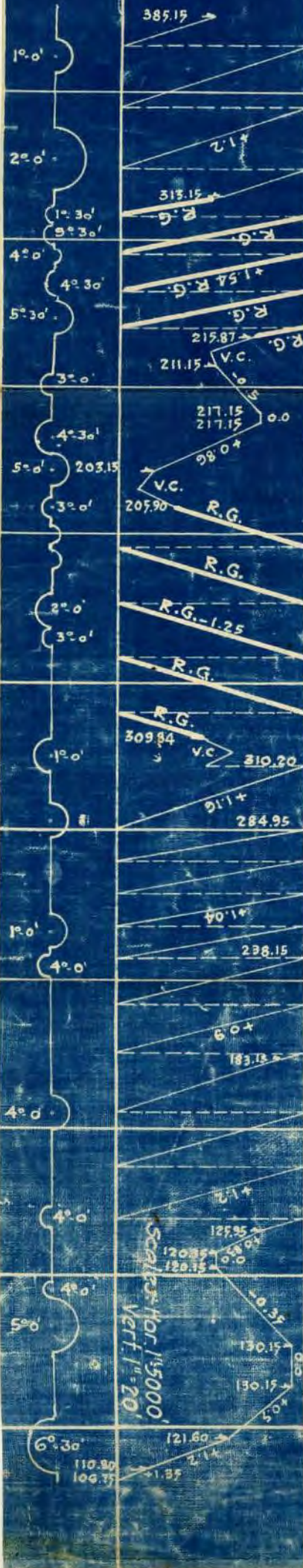
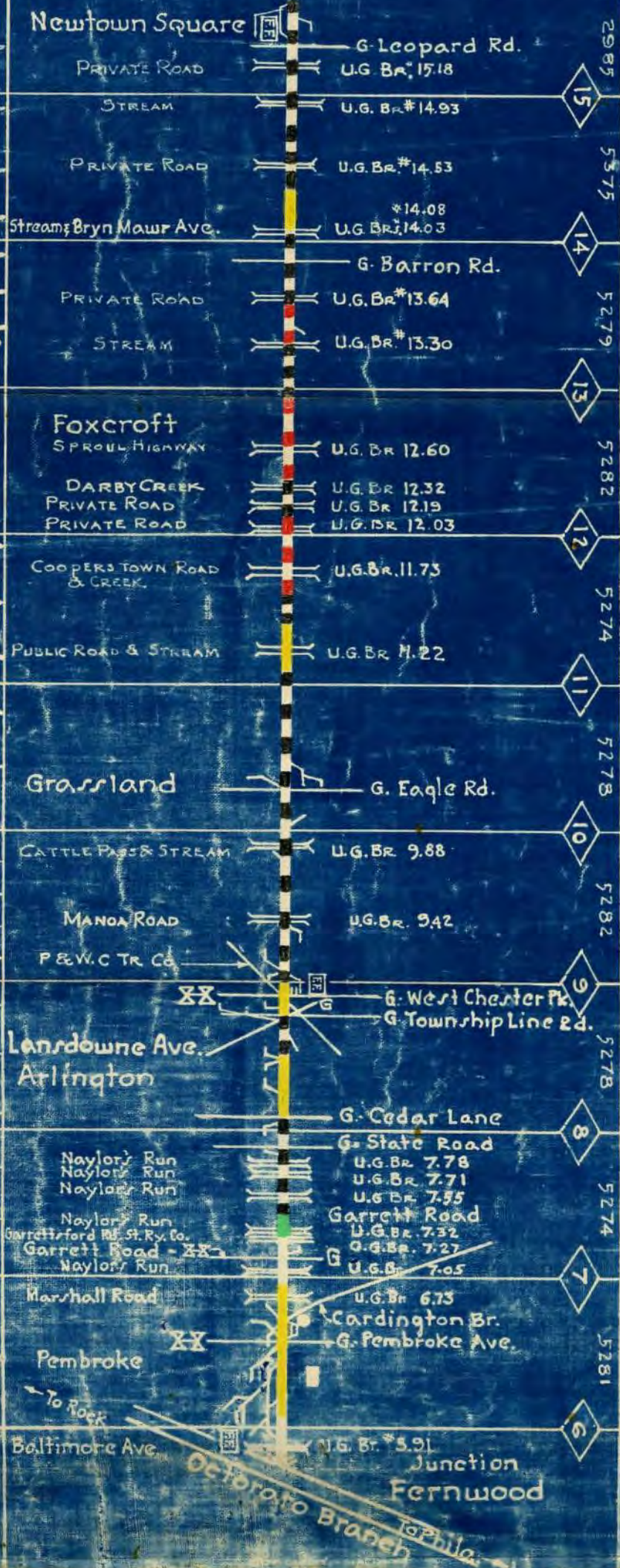

Downloaded from http://P.R.K. Railfan.net - Collection of Bill Strasser/ Rail Data Exchange Collection - Commercial reproduction or distribution prohibited

REVISOR No 23 E. J. Sierleja

| | | | | |
|-----------------|----|-----------------|----|---|
| 42 | 44 | 43 | 43 | 3 |
| D. Carmele | | J. Fares | | |
| Total Co. 23.84 | | Main Track 4.63 | | |
| Svr. 117 | | Total Co. 15.04 | | |
| | | Switchers 115 | | |

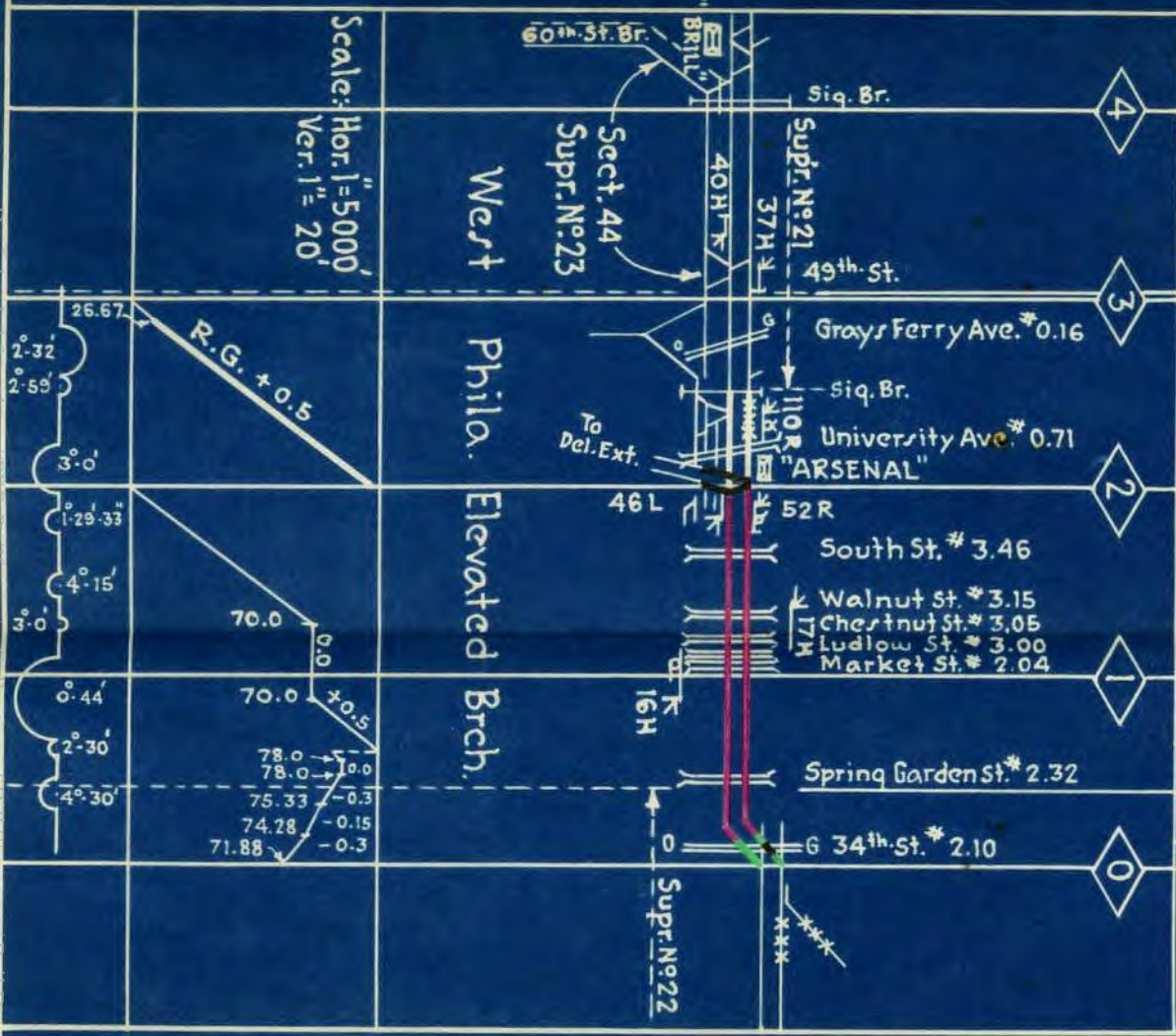

SUPR. No. 23

| | | | | |
|---------------------|---|---------------------|---|---|
| 43 | 5 | 5 | 5 | 5 |
| J. L. Fares | | Marelli | | |
| Main Track 0.78 Mi. | | Main Track 3.10 Mi. | | |
| Total Co. 0.78 " | | Total Co. 14.10 " | | |
| Switchers 3 | | Svr. 98 | | |
| | | R | | |
| | | S | | |
| | | Switchers 256 | | |

DELAWARE EXTENSION

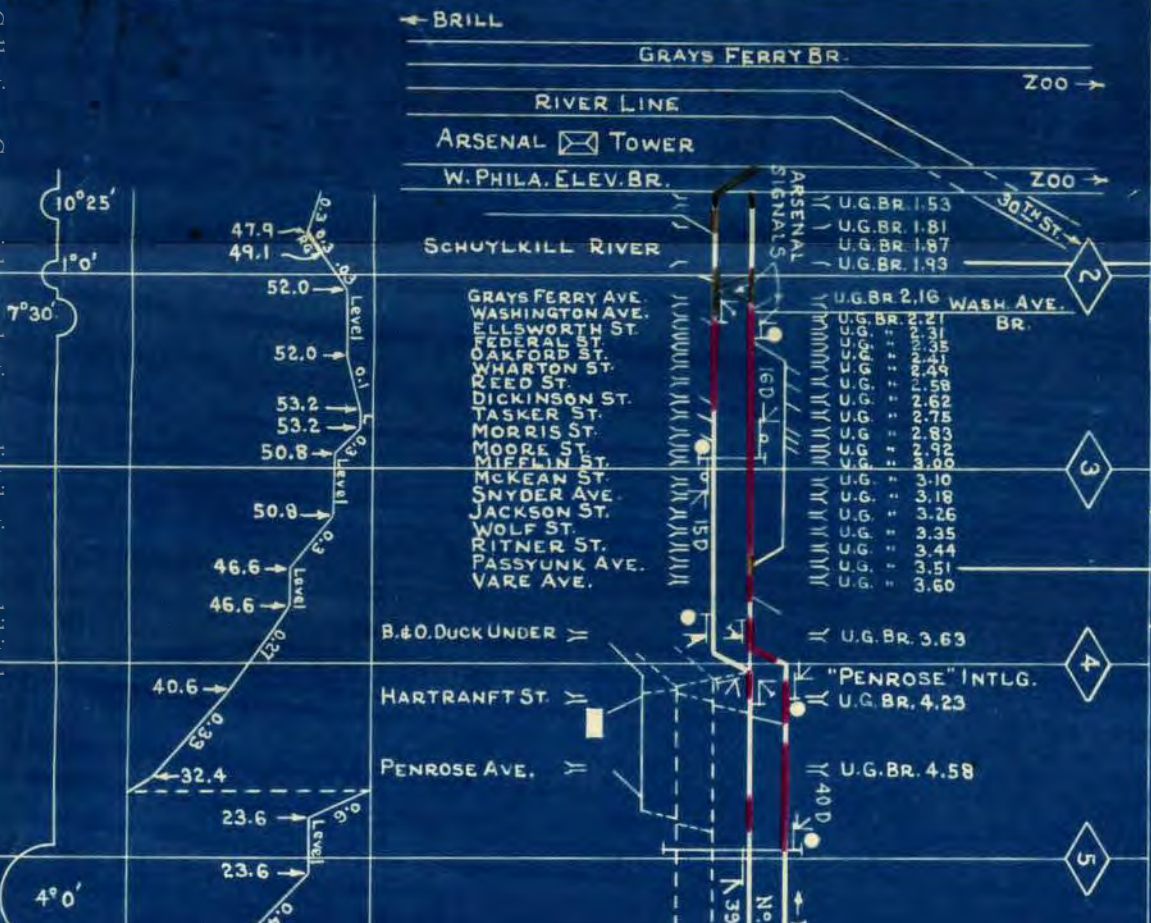

E.J. Sierlaga

A. Ruggieri
M.T.
T.Co. 2640 Mi.
Sws. 143

R B

Open Block

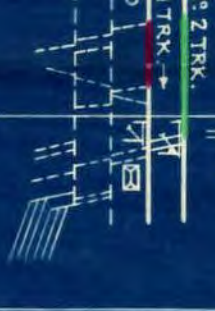

BROAD ST.



Downloaded from

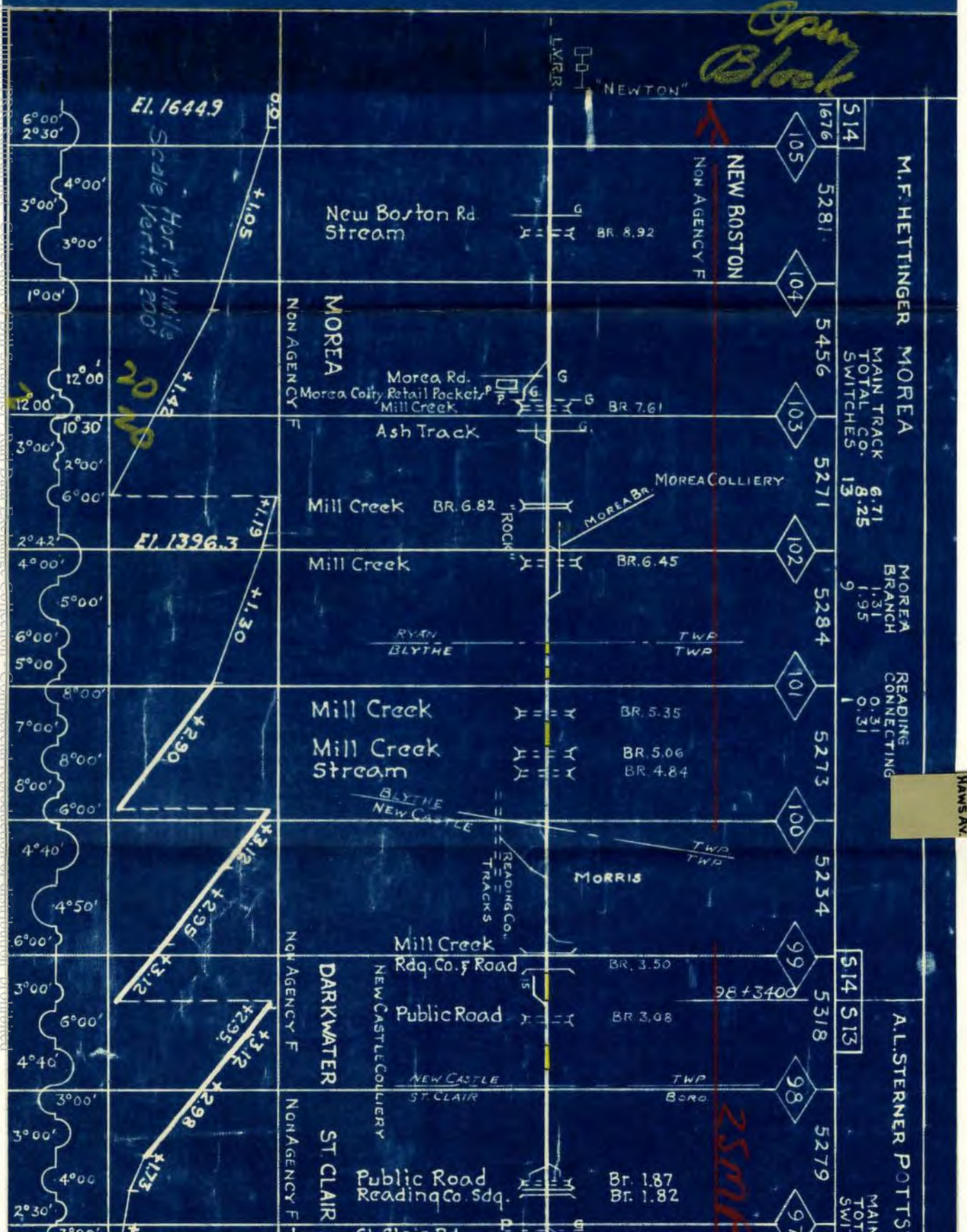

| | | | | | | | | | |
|-----------------------|------|------|------|------|------|------|------|------|------|
| 514 | 1676 | 5281 | 5456 | 5271 | 5284 | 5273 | 5254 | 5318 | 5279 |
| 105 | 104 | 103 | 102 | 101 | 100 | 99 | 98 | 97 | |
| M.F. HETTINGER MORREA | | | | | | | | | |
| MAIN TRACK | | | | | | | | | |
| TOTAL CO. | | | | | | | | | |
| SWITCHES | | | | | | | | | |
| 6.71 | | | | | | | | | |
| 8.25 | | | | | | | | | |
| 13 | | | | | | | | | |
| MORREA BRANCH | | | | | | | | | |
| 1.31 | | | | | | | | | |
| 1.95 | | | | | | | | | |
| 9 | | | | | | | | | |
| READING CONNECTING | | | | | | | | | |
| 0.31 | | | | | | | | | |
| 0.31 | | | | | | | | | |

| | | | | | | | | | |
|--------------------|-----|-----|-----|-----|-----|-----|-----|-----|-----|
| 514 | 513 | 512 | 511 | 510 | 509 | 508 | 507 | 506 | 505 |
| A.L. STERNER POTTS | | | | | | | | | |
| MAIN TRACK | | | | | | | | | |
| TOTAL SWI | | | | | | | | | |

NEW BOSTON TO HAWMS AV.

Downloaded from [illegible] Copyright of [illegible] All rights reserved. No part of this publication may be reproduced, stored in a retrieval system, or transmitted, in any form or by any means, electronic, mechanical, photocopying, recording, or by any information storage and retrieval system, without permission in writing from the publisher.

C. G. Lybarger

SUPERVISOR No. 76

READING,

| | | |
|------------------|------------|-------|
| VILLE | TRACK | 5.07 |
| AL | CO. | 9.01 |
| 33 | | |
| MINERSVILLE | BRANCH | 7.32 |
| | | 11.52 |
| | | 24 |
| J. H. GOAD | MAIN TRACK | 9.59 |
| SCHUYLKILL HAVEN | TOTAL CO. | 18.44 |
| | SWITCHES | 47 |



Downloaded from https://www.cambridge.org/core. University of Cambridge, on 02 Dec 2019 at 10:00:00, subject to the Cambridge Core terms of use, available at https://www.cambridge.org/core/terms. https://doi.org/10.1017/9781107300000.008

S12 S11

H. F. SCHAEFER.

PORT CLINTON

MAIN TRACK 10.00
TOTAL CO. 11.98
SWITCHES 16

5284
5485
5079
5295
5267
5287
5268
5337
5243
5274
5282
5

85
84
83
82
81
80
79
78
77
76
75

HAMBURG

Black Diamond

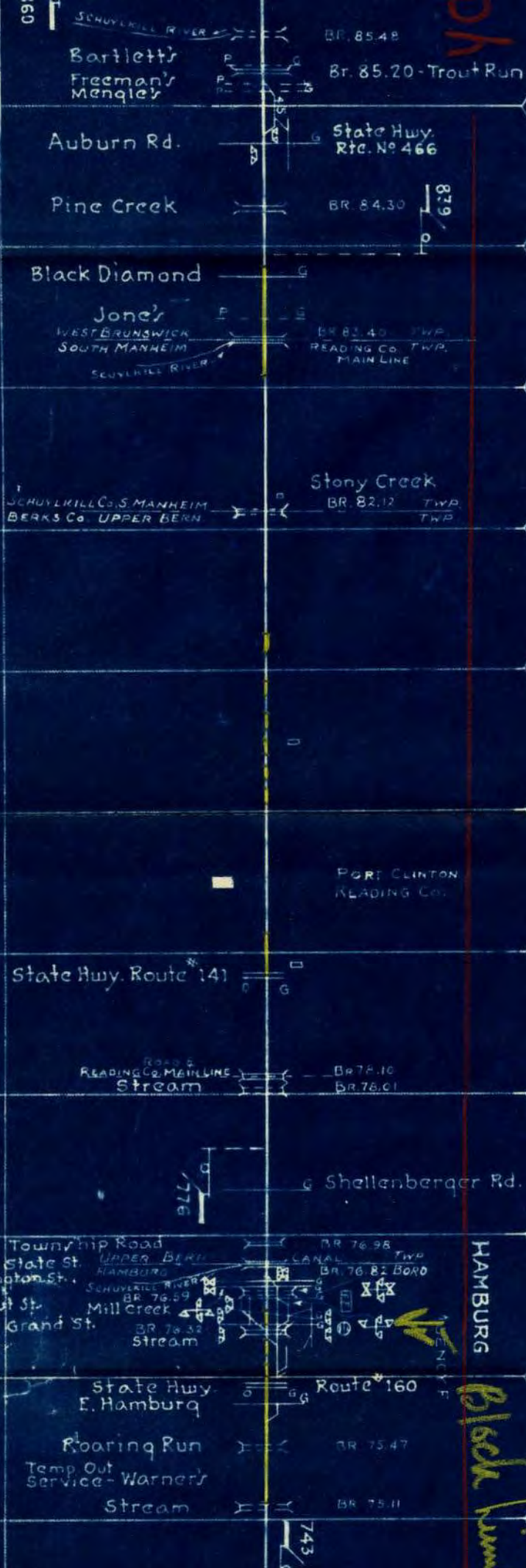

El. 457.0

El. 473.3

El. 361.2

El. 364.2

Downloaded from http://www.kanit.com/ - Collection of Bill Strassner / Rail Data Exchange Collection - Commercial reproduction or distribution prohibited

511 510

F. R. STOUT SHOEMAKERSVILLE
MAIN TRACK 9.98
TOTAL CO. 13.72
SWITCHES

510 59

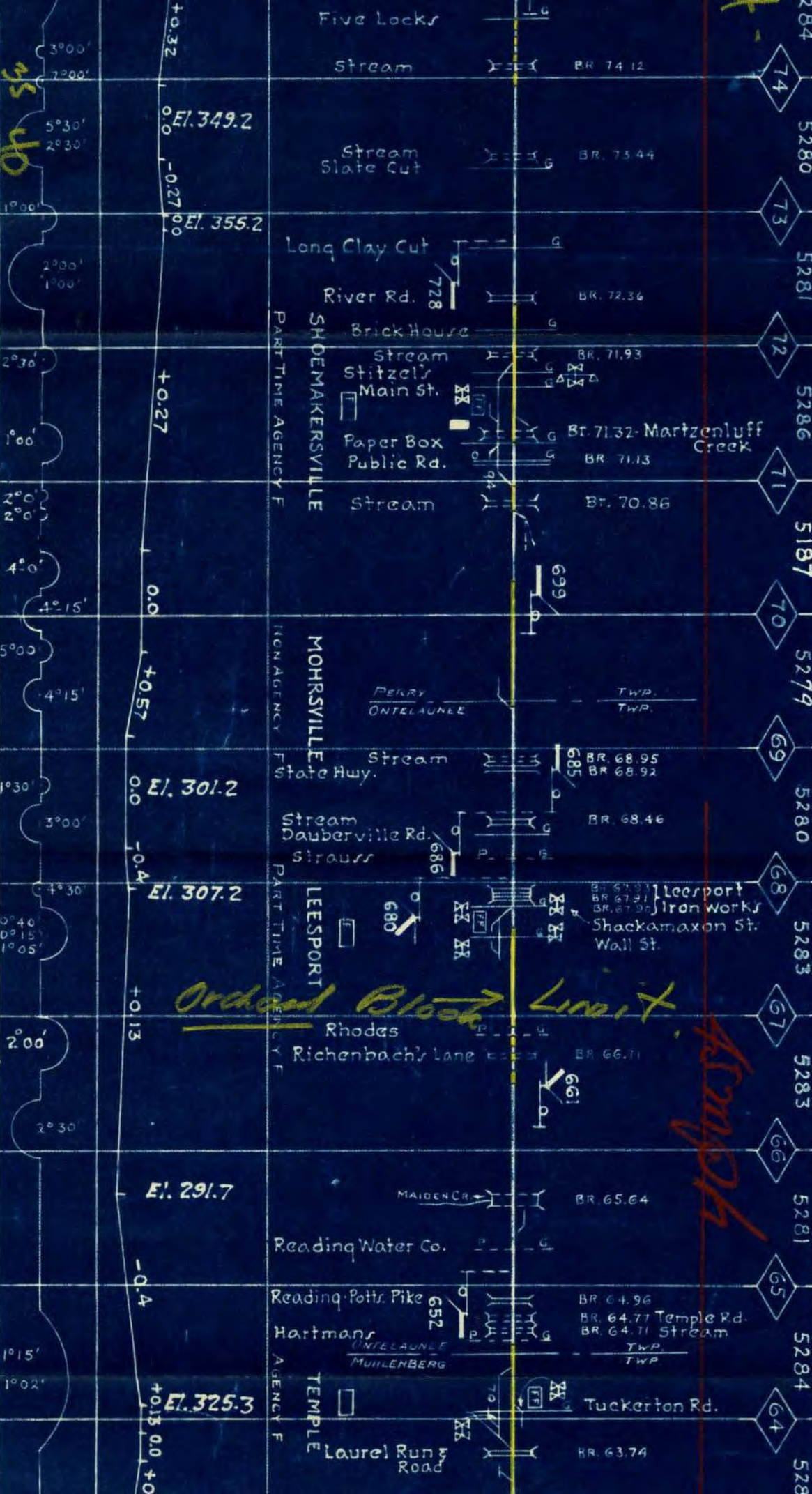

45 46

Order Block Limit

Asmpok

Downloaded from http://www.RailData.net - Collection of Bill Strasser / Rail Data Exchange Collection - Commercial reproduction or distribution prohibited

MAIN TRACK 10.00
TOTAL CO. SWITCHES 12.30

MAIN TRACK 0.84
TOTAL CO. SWITCHES 19



R. KNAUER
BIRDSBORO

MAIN TRACK
TOTAL
CO.
SWITCHES
10.00
15.63
34

J. BULHAROWSKI

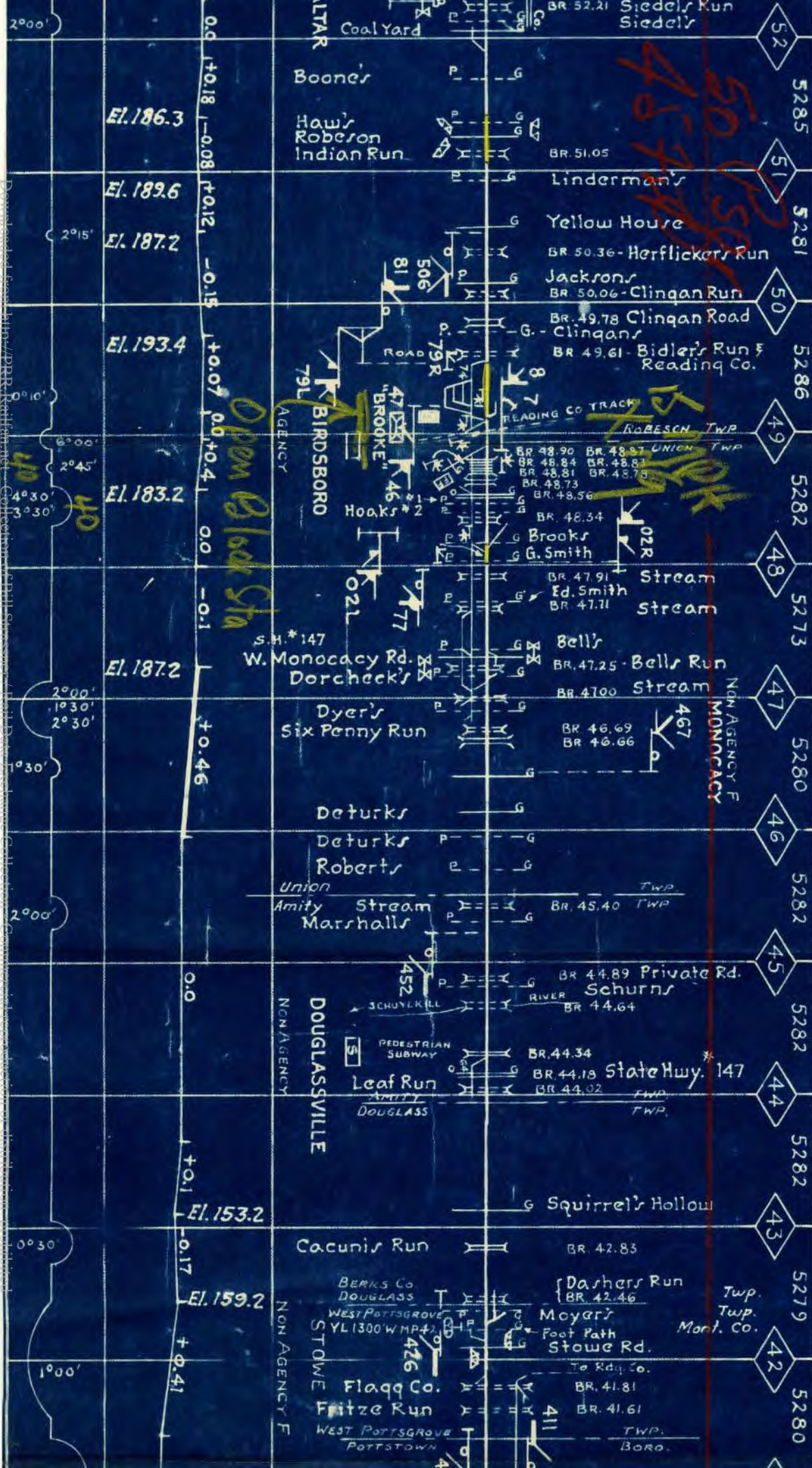

El. 186.3

El. 189.6

El. 187.2

El. 193.4

El. 183.2

El. 187.2

El. 153.2

El. 159.2

58 57

C.G. Lybarger - SUPERVISOR No. 76 READING, PA.

| | | | | |
|------------|----|------|------------|-------|
| POTTSTOWN | 41 | 5256 | MAIN TRACK | 10.00 |
| | 40 | 5308 | TOTAL CO. | 31.57 |
| | 39 | 5280 | SWITCHES | 39 |
| | 38 | 5284 | | |
| | 37 | 5279 | | |
| | 36 | 5279 | | |
| | 35 | 5277 | | |
| | 34 | 5283 | | |
| | 33 | 5281 | | |
| | 32 | 5280 | | |
| | 31 | 5273 | | |
| | 30 | | | |
| ROYERSFORD | | | MAIN TRACK | 9.13 |
| | | | TOTAL CO. | 16.29 |
| | | | SWITCHES | 49 |

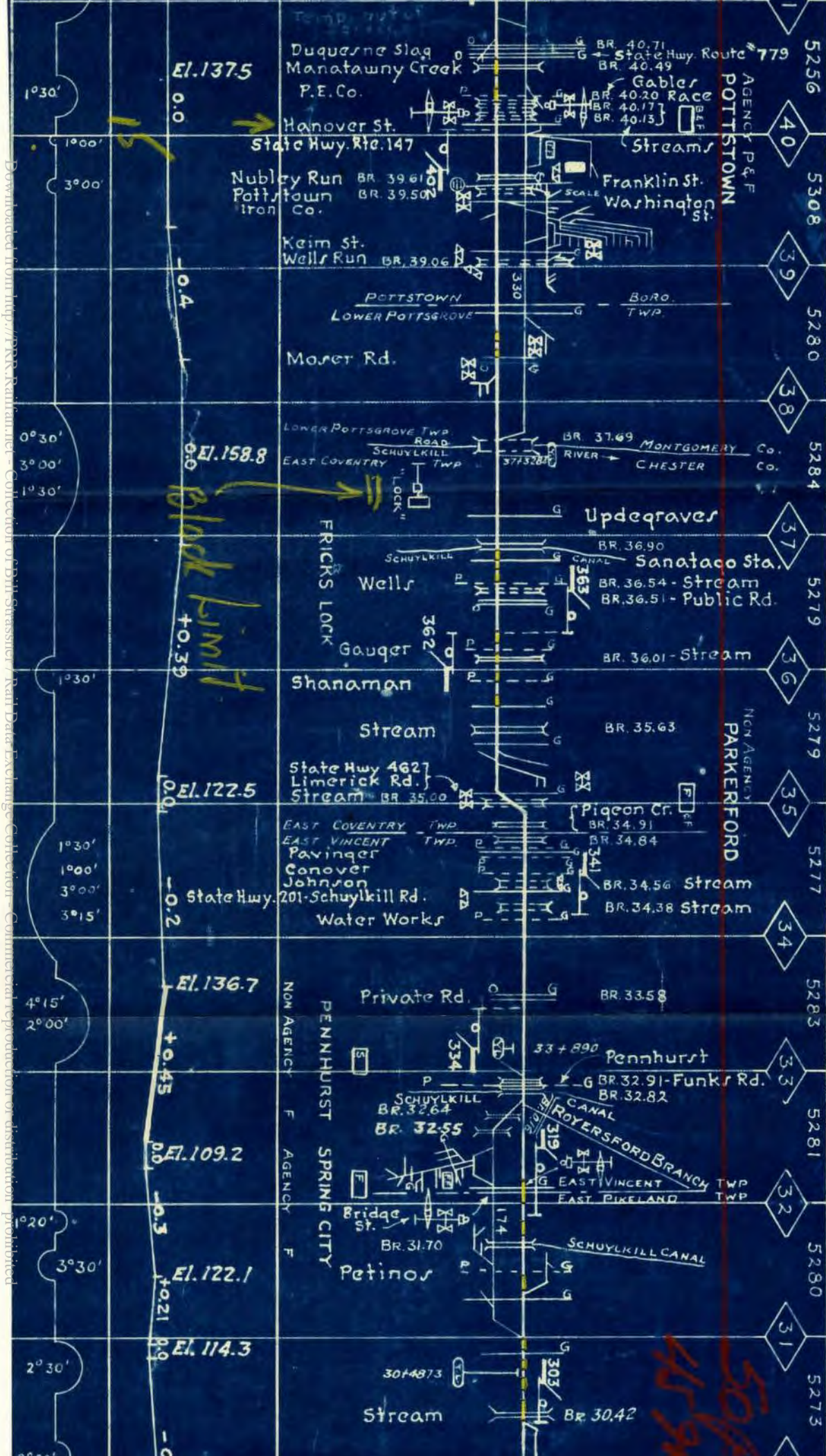

Distributed from http://www.Rainwater.com - Collector of Bill Stammers' Rain Data Exchange Collection - Commercial reproduction or distribution prohibited

Supervisor No: 76

| | | |
|-----------|---------------------|------------------|
| RD BRANCH | PHOENIXVILLE BRANCH | BETZWOOD |
| CK 1.04 | MAIN TRACK 6.04 | MAIN TRACK 14.76 |
| 16 1.79 | TOTAL CO. 9.26 | TOTAL CO. 16.74 |
| | SWITCHES 27 | SWITCHES 18 |
| | 5655 | 555 |

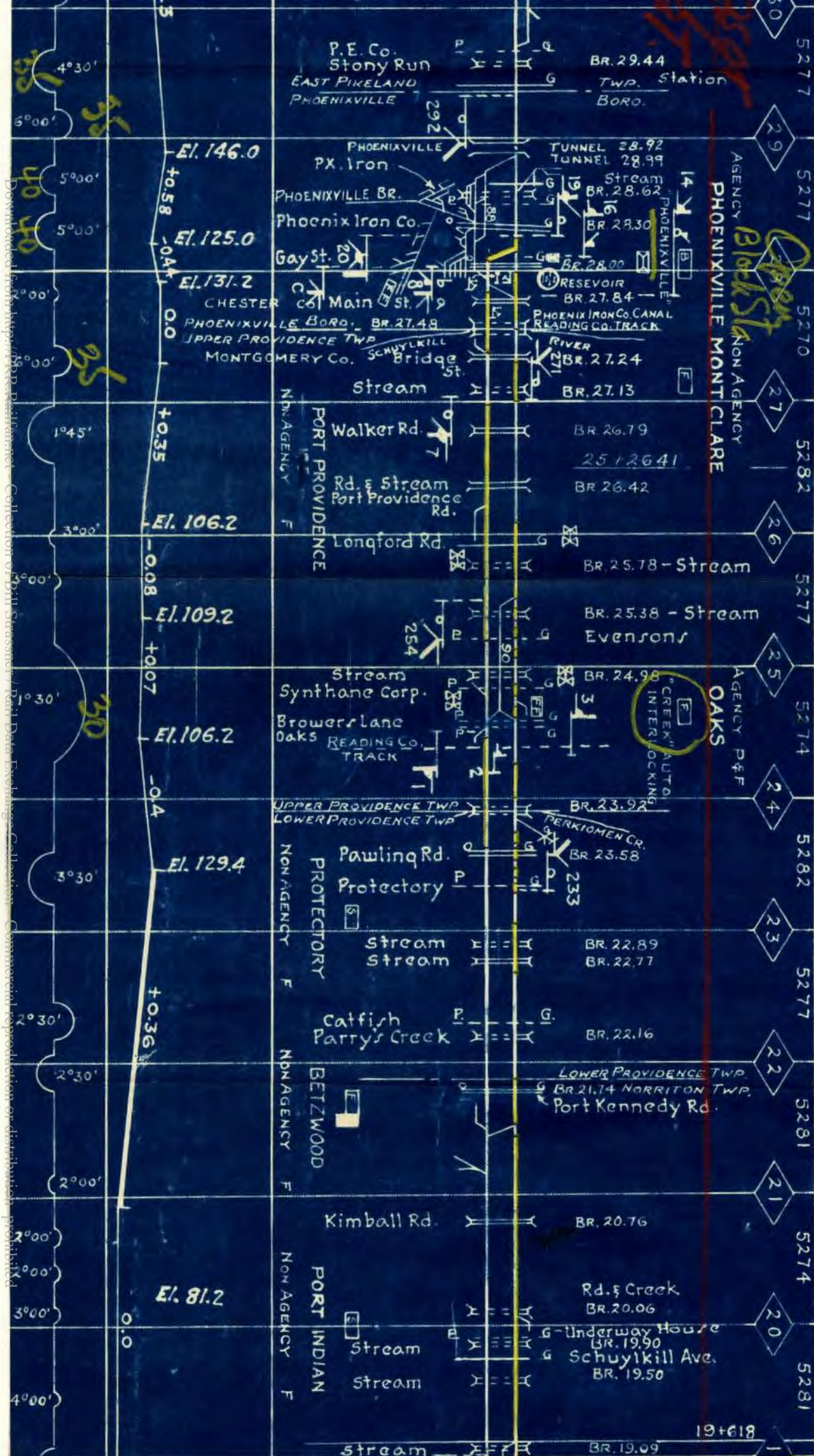

Downloaded from https://www.industrydocuments.ucsf.edu/docs/...

Sub. Div. 22

G.B. Silvestre "Norris"

Main Track 8.23 Miles
Total Co. 19.64
Switches 84

52nd St.

Supervisor No. 22 W.K. Manquom

Tony Ianni Conshohocken

Main Track 12.00 Miles
Total Co. 14.16
Switches 18

Asst. Sup N.

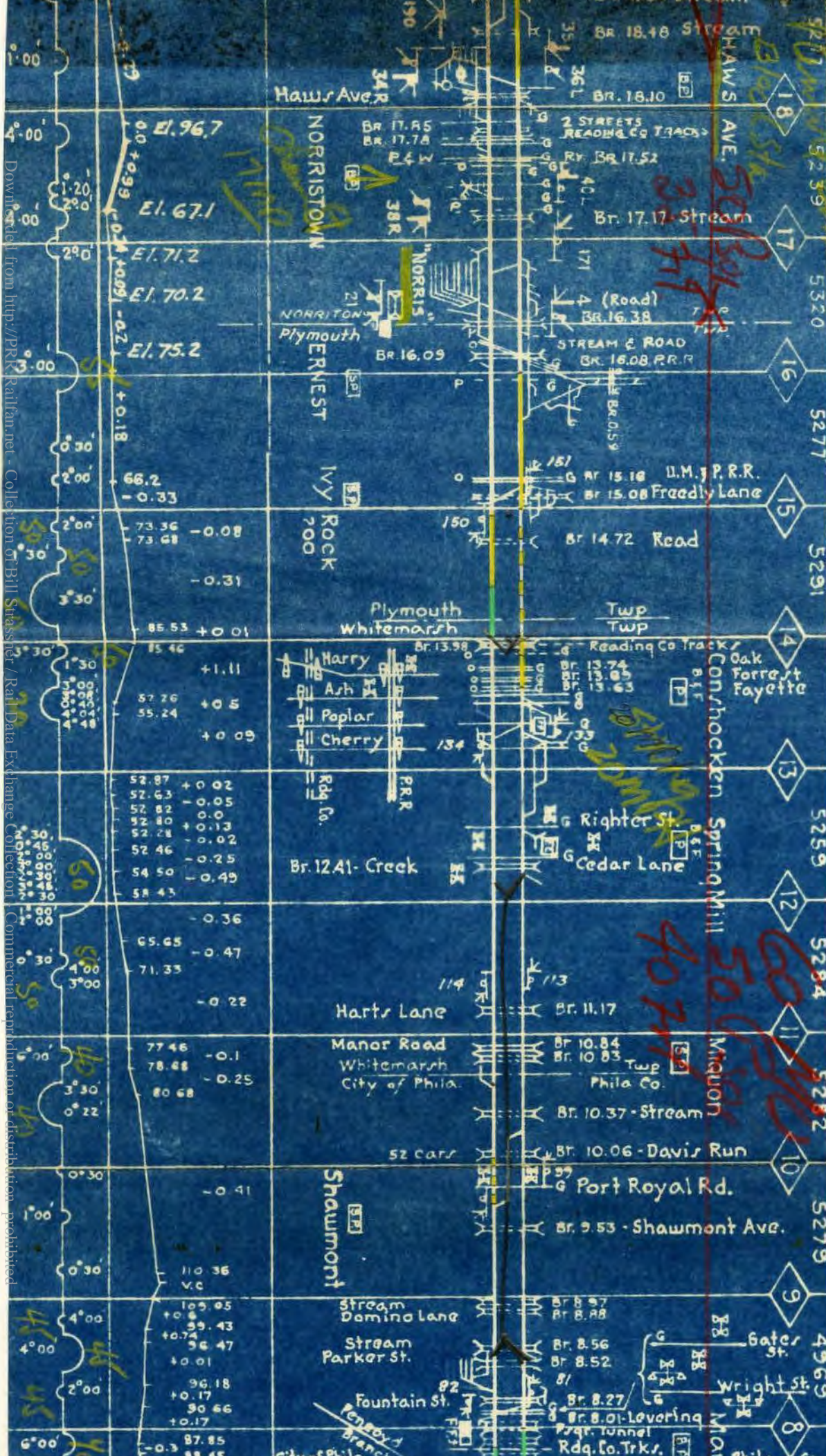

5239
5320
5277
5291
5259
5284
5282
5279
4969

5-2 S-1

Downloaded from <http://PRK.Railfan.net> - Collection of Bill Strasser / Rail Data Exchange Collection. Commercial reproduction or distribution prohibited.

DIVISOR - G. E. Ellis

Mademarco Monayunk
Main Track 10.44 Miles
Total Co. Switches 44
S. 1.4
Part of Sec 4
See Main Line



FRAZER



Scale: - Hor. 1" = 1 Mile
Vert. 1" = 200'

EAST WHITELAND TWP.
CHARLESTOWN TWP.



El. 365.0
El. 373.0



MAIN TRACK TOTAL SWITCHES

G. IANNI PHOENIXVILLE

PHOENIX

VILLE BRANCH
 CRACK 6.04
 Co. 9.26
 ES 29

ALDHAM
 PICKERING
 WILMER
 PHOENIXVILLE

5235
 5296
 5879
 4574
 3676

56
 56

A.L. STERNER POTTSVILLE

MINERSVILLE

MAINT. TOTT SWIT

Henry Geib P
 Sheilack P
 Reeser Road
 Stream

State Rd. & Pickering
 Creek BR. 3.08

CHARLESTOWN
 SCHUYLKILL Stream
 Buckwalter's Road BR. 2.71
 BR. 2.68

Stream
 Ester Rusta BR. 2.23

SCHUYLKILL
 PHOENIXVILLE TWP.
 BORO.

Nuttz Ave. BR. 0.94

Br. 0.54
 Br. 1.09
 60'
 READING Co.
 ← To PHILA.
 MAIN LINE SCHUYLKILL
 BRANCH

PHOENIXVILLE

Mine Drift Track
 7+3482 END
 BR. 7.23
 BR. 7.11 - Lytle Coal Tpk.
 BR. 7.05 - Lytle Coal Co.
 (Footbridge)

New Castle St. BR. 4.75

OAK HILL COLLIERY

CASS
 MINERSVILLE
 SCHUYLKILL RIVER
 MINERSVILLE
 NORWEGIAN
 BR. 3.98 - Delaware Ave.
 BR. 3.84 - Rdq. Co. Track

MINERSVILLE
 PART TIME
 P. G. Penner's
 P. G. Holley

El. 336.3
 *1.65
 El. 255.7
 *1.7
 El. 174.9
 El. 170.0
 *0.7
 El. 173.0
 *0.2
 *1.2
 El. 213.0
 0.0+0.4
 El. 207.0
 *1.3
 El. 125.0
 0.0

El. 956.0
 -1.8
 El. 1017.0
 *2.39
 El. 931.7
 *1.8
 El. 902.1
 *2.93
 El. 921.0
 *2.93
 -1.8

Downloaded from https://www.cambridge.org/core. University of Cambridge, on 02 Jun 2018 at 10:00:00, subject to the Cambridge Core terms of use, available at https://www.cambridge.org/core/terms. https://doi.org/10.1017/S0014180100000000

BR.

SUPERVISOR No. 76

E. ANCH 1

1 TRACK 7.22
TOTAL CO. SWITCHES 2
5280
5280
5280
513



Public Road BR. 1.97
 NORWEGIAN CITY
 POTTSVILLE BR. 1.27 G. Eaqsns Twp.
 NORWEGIAN CREEK
 READING Co. TRACK
 Heffner St. & Br. 0.58 - Ravine St.
 Rdq. Co. Tr'k. Br. 0.47 Rdq. Co. Tr'k.
 Br. 0.38 - Peacock St.
 Br. 0.21 Coal St. & Center St.

MAIN LINE
 SCHUYLKILL BR.

M.F. HETTINGER
 MAIN TRACK
 TOTAL CO. SWITCHES 1.31
 1.95
 514

MOREA



MOREA BRANCH
 Mill Creek BR. 6.70
 Water Dam
 SCHUYLKILL BR.
 MOREA BREAKER
 L.V.R.R.

GIRARDVILLE BRANCH

M.F. HETTINGER-SHENANDOAH
 MAIN TRACK
 TOTAL CO. SWITCHES 3.095
 5218
 2.14
 3.77
 2038
 515

SHENANDOAH



SHENANDOAH AGENCY F
 BR. 4.53
 WM. PENN. COLLIERY
 L.V.R.R.
 0+00
 Besing Co.