

# TRACK CHART



PENNSYLVANIA SYSTEM

EASTERN REGION

PHILA. DIV.

MAIN LINE

GREENTREE      MARYSVILLE

SCALE: 1"=1 MILE

HARRISBURG      PENNA.

CORRECT TO

JAN. 1 - 1931









# LEGEND

FRY STR BRICK	FRAME	SHELTER
PROSSER BRICK	"	"
INTERLOCKING TOWER		
BLACK STATION		
WATCH BOX		
TOOL HOUSE		
TELEPHONE BOOTH OR BOX		
ASH PIT		
PUBLIC ROAD CROSSING-GRADE		
PRIVATE "		
OVERHEAD BRIDGE		
TUNNEL		
GIEDER - BRIDGE		
SLAB		
ARCH		
SIGNAL		
WATER STATION		
" TANK		
" PLUG		
TRACK PAN		
YARD LIMIT		
SIGNAL MAST		
SUB-STATION		
DRAINING EQUIPMENT		
STATE-COUNTY-TWO-BORO LINES		
165 LB. RAIL		
152 "		
140 "		
133 "		
131 "		
130 "		
127 "		
125 "		
112 "		
100 "		
85 "		
LESS THAN 85 LBS.		
TRACKS SIGNALLED BOTH DIRECTIONS		

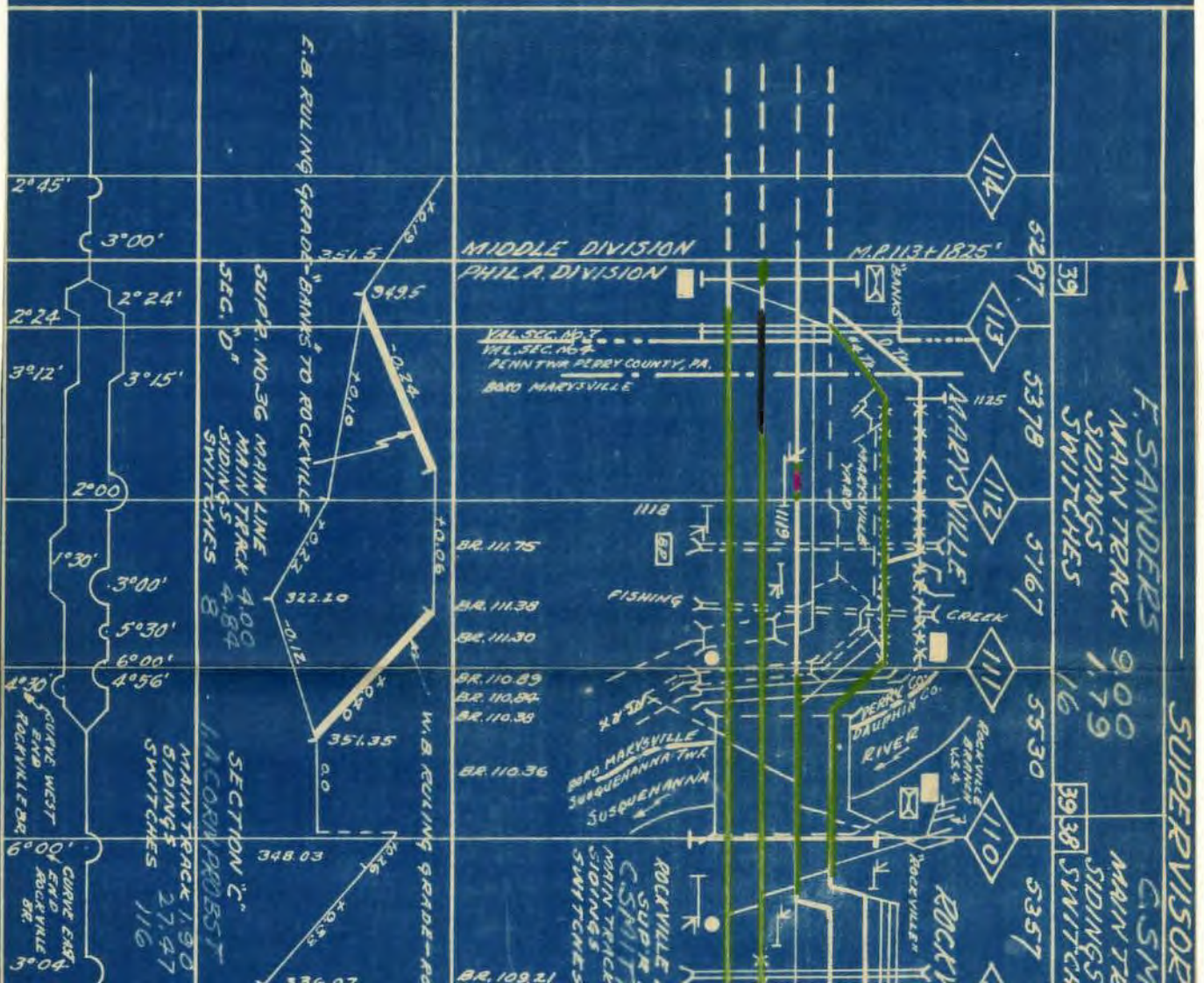



HARRISBURG, PA.

S. A. GEBHART  
MAIN TRACK

SWITCHES  
SIOING5

311	5273
-----	------

66

STEELTON  
YARD

5  
23  
N/A  
186



●

KE  
OF  
OF  
96

IRNPI  
30.50  
30.00

NO. 34

63  
58  
31  
21  
26

4.98.  
2.98.5  
2.98.5  
2.98.5  
2.98.5  
2.98.5

BA  
BA  
BA  
BA  
BA

ARRISBURG TO ROYAL

309.1

---

309.0

A graph of the linear function  $y = 10.01x + 10.00$ . The x-axis is labeled from 0.0 to 10.0, and the y-axis is labeled from 0.0 to 10.0. The line passes through the points (0, 10.00) and (10, 10.01).

ERETIGHT TRACK

0°30'

2'

0-1

and

prohibited

Downloaded from <http://P.R.R.Railfan.net> - Collection of Bill Strassner / Rail Data Exchange Collection - Commercial reproduction or distribution prohibited



1

H.B.N  
MA  
SID  
544

31	30
----	----

ELIZABETH





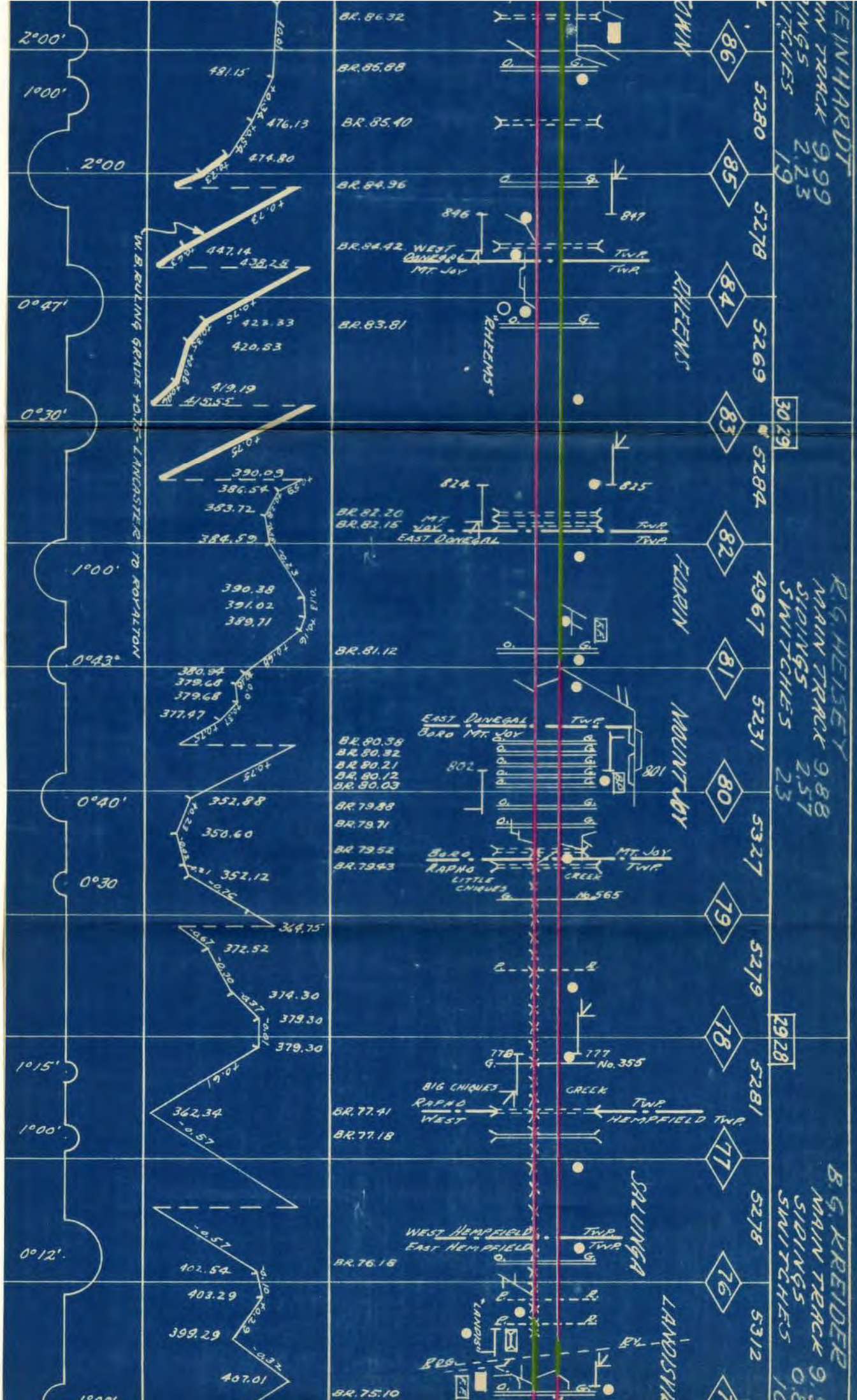

MAIN TRACK 9.99  
SIGNALS 2.23  
SWITCHES 19

BR. HEISEY  
MAIN TRACK 9.88  
SIGNALS 2.57  
SWITCHES 23

BR. KREIDER  
MAIN TRACK 9.88  
SIGNALS 0.88  
SWITCHES 10



SUPERVISOR NO. 32 J.C. GOLAB

LANCASTER, PA.

2827

R. FRYNER  
MAIN TRACK 7.51  
SIDINGS 0.16  
SWITCHES 5

2726

L. VORANO  
MAIN TRACK 8.66  
SIDINGS 8.46  
SWITCHES 89

2625

C. HAGELGA  
MAIN TRACK  
SIDINGS  
SWITCHES

5244

74

5281

73

5277

72

5291

71

5270

70

1430

69

5284

68

5280

67

5277

66

5277

65

5280

64

5

BR. 74.39  
BR. 74.37

BR. 73.22

BR. 72.66

BR. 72.31

BR. 71.55  
EAST HEMPFIELD  
MANHEIM

BR. 71.01

BR. 70.61

BR. 70.01

BR. 68.74

BR. 68.15  
BR. 68.10  
BR. 67.87  
BR. 67.85  
BR. 67.76

BR. 67.54  
BR. 67.53

BR. 67.33

BR. 67.15

BR. 66.98  
BR. 66.95

BR. 66.35  
LANCASTER  
MANHEIM  
EAST LANCASTER

BR. 65.78

BR. 65.01

BR. 64.18

736

735

No. 33

718

717

No. 32

717

717

717

717

717

717

717

717

717

717

717

717

717

717

717

717

717

717

717

717

717

717

717

717

717

717

717

717

717

717

717

717

717

717

366.33

356.98

316.19

316.19

329.97

329.97

354.27

316.10

316.10

316.10

316.10

316.10

316.10

316.10

316.10

316.10

316.10

316.10

316.10

316.10

316.10

316.10

315.49

1'08"

1'00"

1'00"

1'00"

1'06"

0°45'

4'0"30"

1'0°45'

0°20'



P. I. C.  
MAIN  
SIDE  
SW

KINZEP

六

100

10.56

Downloaded from <http://PRR.Railfan.net> - Collection of Bill Strasser / Rail Data Exchange Collection - Commercial reproduction or distribution prohibited



OFF-ROAD  
TRACK 16.00  
SIDINGS 0.48  
SWITCHES 4

W.L. ARMER  
MAIN TRACK 10.43  
SIDINGS 0.67  
SWITCHES 3

R.C. STEVENS  
MAIN TRACK 11.87  
SIDINGS 0.71  
SWITCHES 5

J.H. DONLEY  
MAIN TRACK 9.32  
SIDINGS 1.53  
SWITCHES 21

C.C.A.  
MAIN TRACK 9.32  
SIDINGS 1.53  
SWITCHES 21

SUPERV

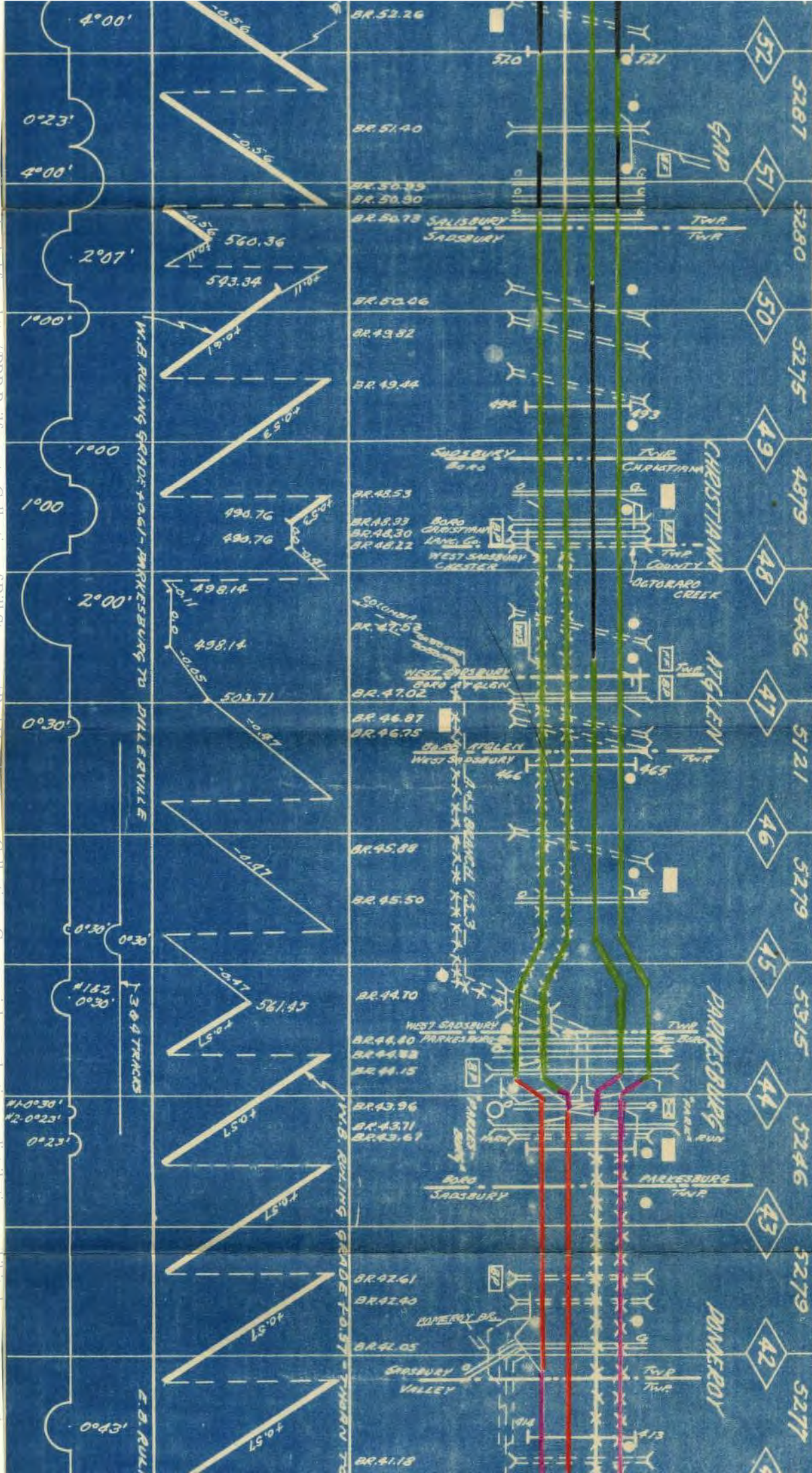







ASST. SUPERVISOR C. E. GLEEDY

TALDOL  
TRACK 12.68  
0.17

J. M. DERMOY  
MAIN TRACK 15.31  
SIDINGS  
SWITCHES 0.92

J. W. BUCKLEY  
MAIN TRACK 11.99  
SIDINGS  
SWITCHES 0.31

11

5278 5280 5256 5303 5278 5281 5279 5281 5277

29 28 27 26 25 24 23 22 21 20

WHITFORD

WHITELAND

WHITFORD

MALVERN

SHIP ROAD

GLEN LOCH

FRAZER

WILSONVILLE

MALVERN

NP21-1936

EAST BRADFORD  
EAST CALN  
EAST CALN  
WEST WHITELAND

BR. 29.17  
BR. 29.06  
BR. 28.83  
BR. 28.38  
BR. 28.35

BR. 27.56  
BR. 27.47

BR. 26.70  
BR. 26.53  
BR. 26.04

BR. 25.40  
BR. 25.36  
BR. 25.04  
BR. 25.00  
BR. 24.70  
WEST CHESTER BRANCH

BR. 24.34

BR. 23.53  
BR. 23.51  
BR. 23.45  
BR. 23.57

BR. 22.85  
BR. 22.61

BR. 22.10

BR. 21.57  
BR. 21.45

W.A. RAILING GRAND  
MALVERN TO GLEN LOCH

BR. 29.17  
BR. 29.06  
BR. 28.83  
BR. 28.38  
BR. 28.35

BR. 27.56  
BR. 27.47

BR. 26.70  
BR. 26.53  
BR. 26.04

BR. 25.40  
BR. 25.36  
BR. 25.04  
BR. 25.00  
BR. 24.70  
WEST CHESTER BRANCH

BR. 24.34

BR. 23.53  
BR. 23.51  
BR. 23.45  
BR. 23.57

BR. 22.85  
BR. 22.61

BR. 22.10

BR. 21.57  
BR. 21.45

W.A. RAILING GRAND  
MALVERN TO GLEN LOCH

3rd & 4th TRACKS

W.A. RAILING GRAND - GLEN LOCH TO MALVERN

PHILADELPHIA DIVISION  
PHILA. TERMINAL DIVISION

0°09'

0°23'

0°32'

0°40'

0°30'

1°15'

0°30'

0°12'

2°07'

2°07'

2°07'