

# TRACK CHART



**PENNSYLVANIA RAILROAD**

## CENTRAL REGION

**NORTHERN  
DIVISION**

## MAIN LINE

CHAUTAUQUA BRCH.

SCALE 1 INCH = 1 MILE

OFFICE OF CHIEF ENGR. M.W.

**PITTSBURGH, PA.**

**CORRECT**

JAN 1, 1952







## LEGEND:

PASS. STA. BRICK	FRAME	SHED	SHELTER
FRT. " "	" "	" "	" "
INTERLOCKING TOWER			
BLOCK STATION			
TOOL HOUSE			
TELEPHONE BOOTH OR BOX			
ASH PIT			
PUBLIC ROAD XING. (GRADE)			
PRIVATE " "			
OVERHEAD BRIDGE			
GIRDER			
SLAB			
ARCH			
SIGNAL			
WATER STATION			
" TANK			
" PLUG			
YARD LIMIT			
SIGNAL MAST			
STATE, CO & TWP. LINE			
DERAILING EQUIPMENT DETECTOR			
RAIL SECTION			
SPRING SWITCH			
155	SOLID RED		
152	" PURPLE		
140	" BLACK		
133	" BROWN		
131	" GREEN		
130	" WHITE		
127	DASHED BROWN		
125	" YELLOW		
112	" GREEN		
100	SOLID YELLOW		
85	DASHED RED		
LESS THAN 85	DASHED BLACK		

## MAIN LINE

LEGEND	
REMOTE CONTROL SWITCHES	0
ROCK SLIDE PROTECTION SIGNALS	1
BOTH DIRECTIONS	2
ROCK SLIDE FENCES	3

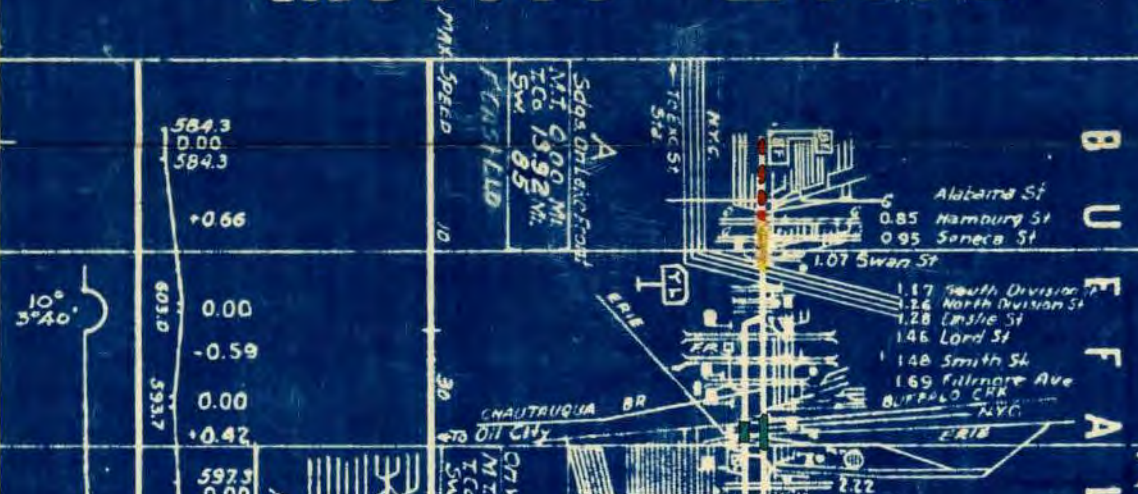







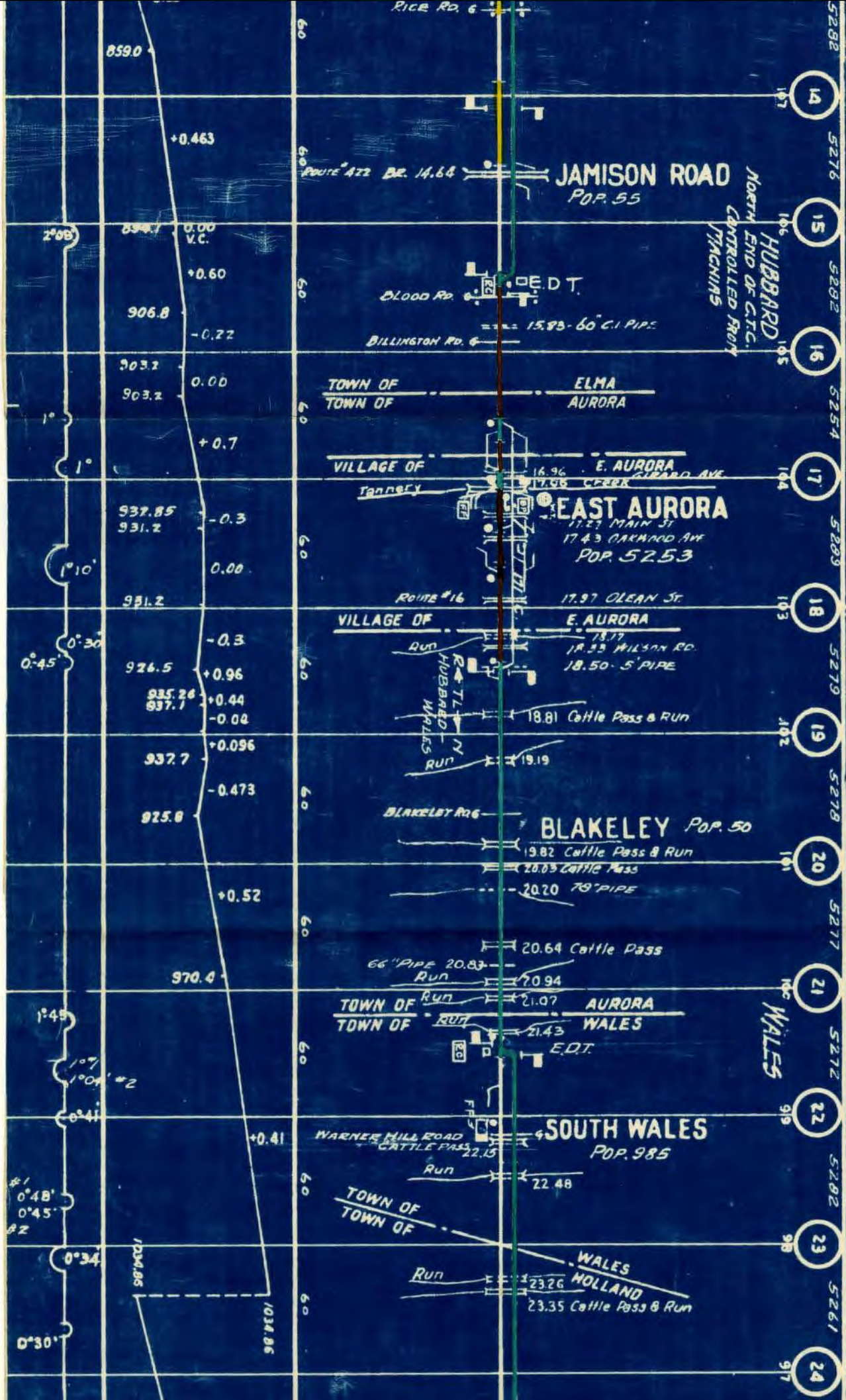



M.T. 8.09 MI.  
T.CO. 9.06 MI.  
SW. 3

7 1/2 - M. H. JACKSON

M.T. 6.50 MI.  
T.CO. 9.73 MI.  
SW. 8

8 - O.H. CLINTON

- 25 5226 5277 96
- 26 5277 5279 95
- 27 5279 5277 94
- 28 5277 5277 93
- 29 5277 5277 92
- 30 5277 5277 91
- 31 5277 5297 90
- 32 5297 5287 89
- 33 5287 5288 88
- 34 5288 5269 87
- 35 5269 86

PEERY

CHAFFEE

BUCK

**HOLLAND**  
POP. 1474

**PROTECTION**  
POP. 186

**CHAFFEE**  
POP. 283

**ERIE CO.**  
**WYOMING CO.**

Run 25.40  
Run 25.74

26.25 Cattle Pass.  
26.46  
Cattle Pass  
HOLLAND RD.

E.D.T.  
28.04 Buffalo Road  
28.19  
5' PIPE  
28.36 Cattle Pass

6' PIPE 28.86 Cattle Pass.  
28.93

RAIL LUBRICATOR  
2 RAILS  
29.57 Cattle Pass  
Creek

TOWN OF  
TOWN OF  
HOLLAND  
SARDINIA

30.12 Cattle Pass  
30.26 O.H.B.  
30.84 5'-6" PIPE

RAIL LUBRICATOR  
PERRY LAKE

QUINT RD.

COURIER SARDINIA RD.

Run 33.64

33.94 Cattle Pass

GENESEE RD.

SCHUTTS CORNERS RD.

TOWN OF SARDINIA  
TOWN OF ARCADE

1241.01  
1241.01

1336.2  
1348.11  
1347.91  
1349.46

1427.71  
AVERAGE 1.19%  
COMPENSATED

1479.6

1447.8  
1458.7

1°04'  
1°04'  
0°30'  
0°30'

3°  
3°12'

3°  
3°



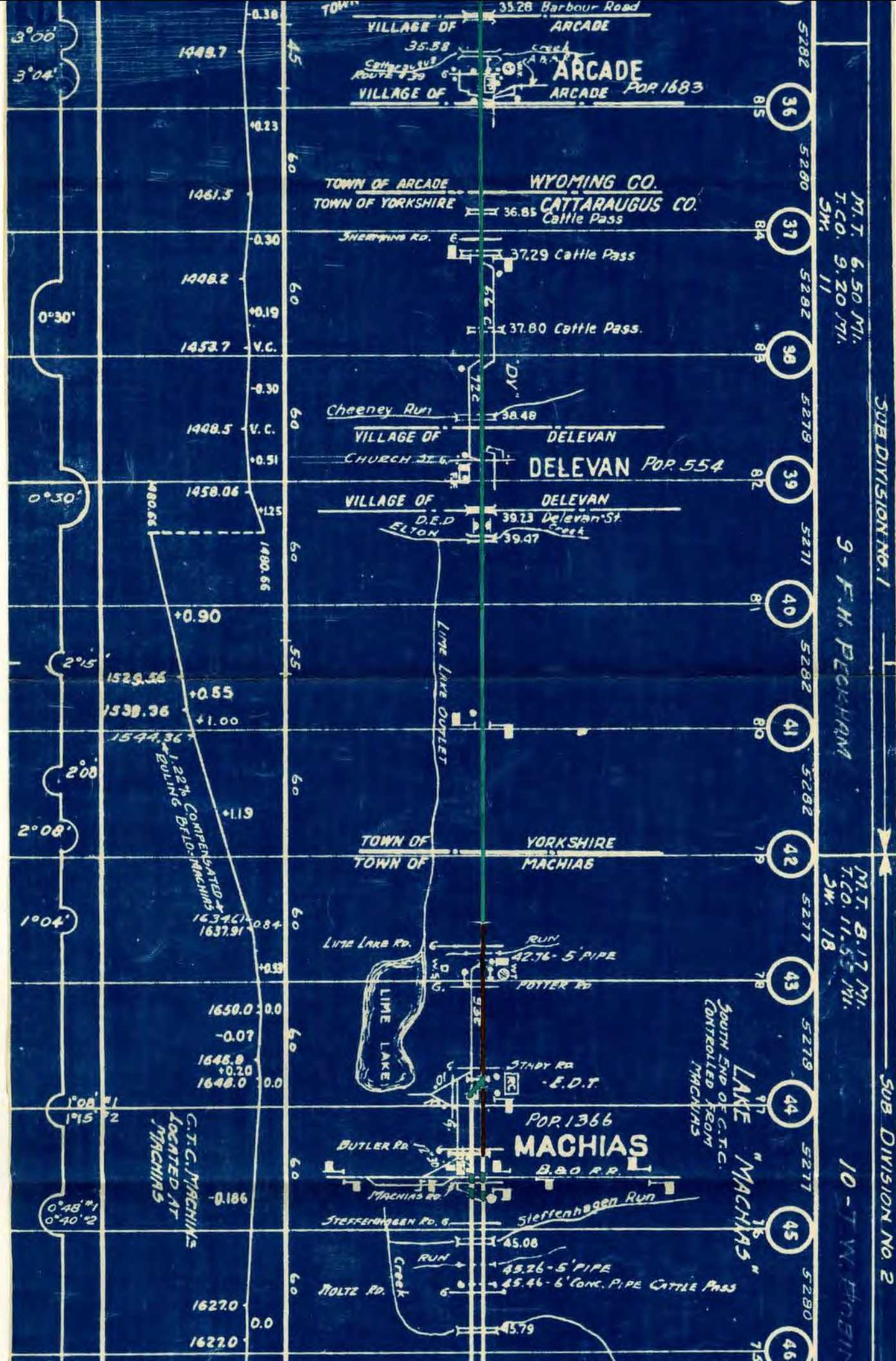

M.T. 6.50 MI.  
T.C.O. 9.20 MI.  
SM. 11

9 - F.H. PECKHAM

M.T. 8.17 MI.  
T.C.O. 11.55 MI.  
SM. 18

10 - J.W. FROBIN

SUB DIVISION NO. 1

SUB DIVISION NO. 2



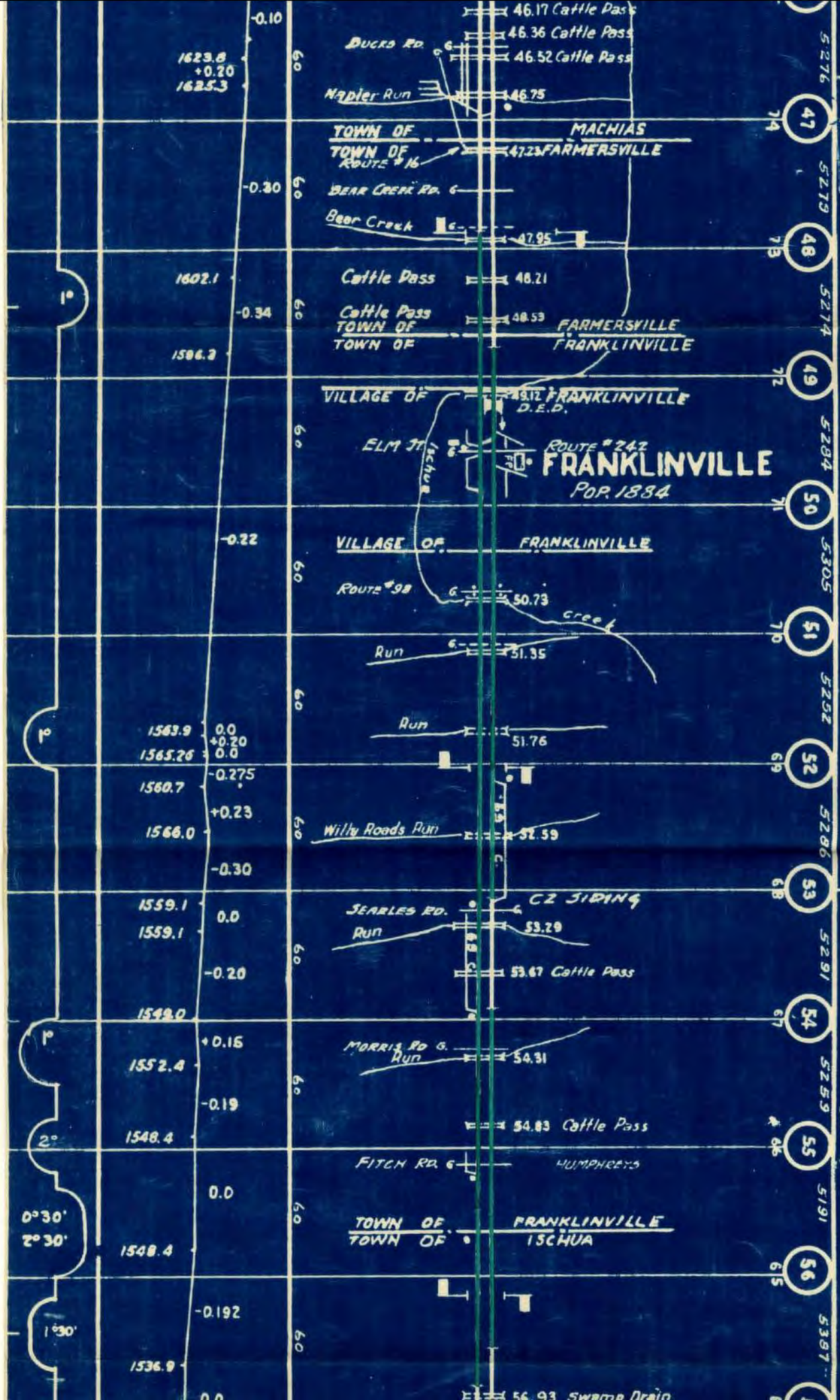

11 - F. FRANKLINVILLE  
M.T. 12.00 M.  
T.C. 12.00 M.  
SW. 1/4  
M.T. 11.77 M.  
T.C. 12.00 M.  
SW. 1/4  
12



ED. LAWSON

M.T. 10.02 MI.  
T.C. 10.60 MI.  
SW. 7

13 - S.A. DAPOLITO

M.T. 10.78 MI.  
T.C. 13.90 MI.  
SW. 13

14 - FRANK

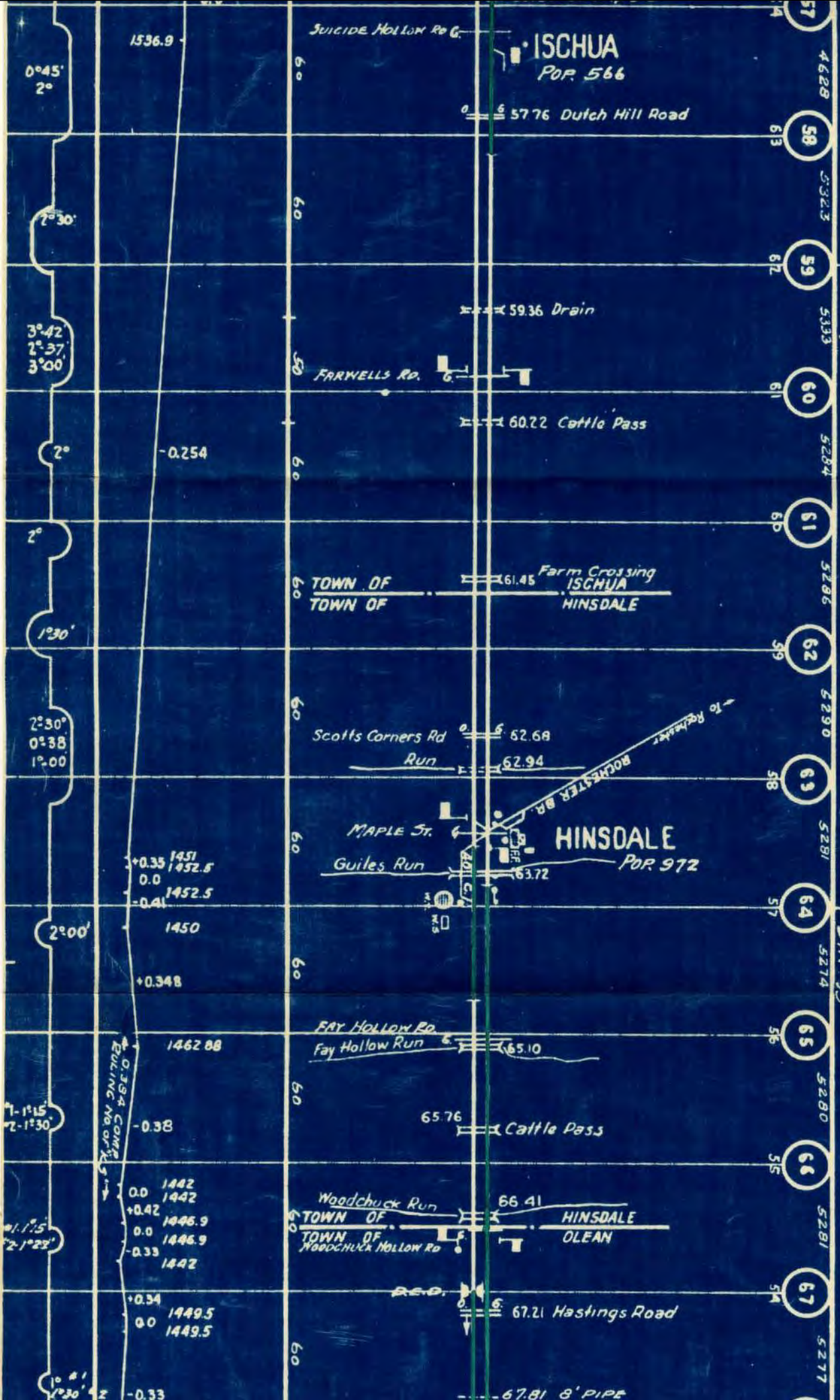



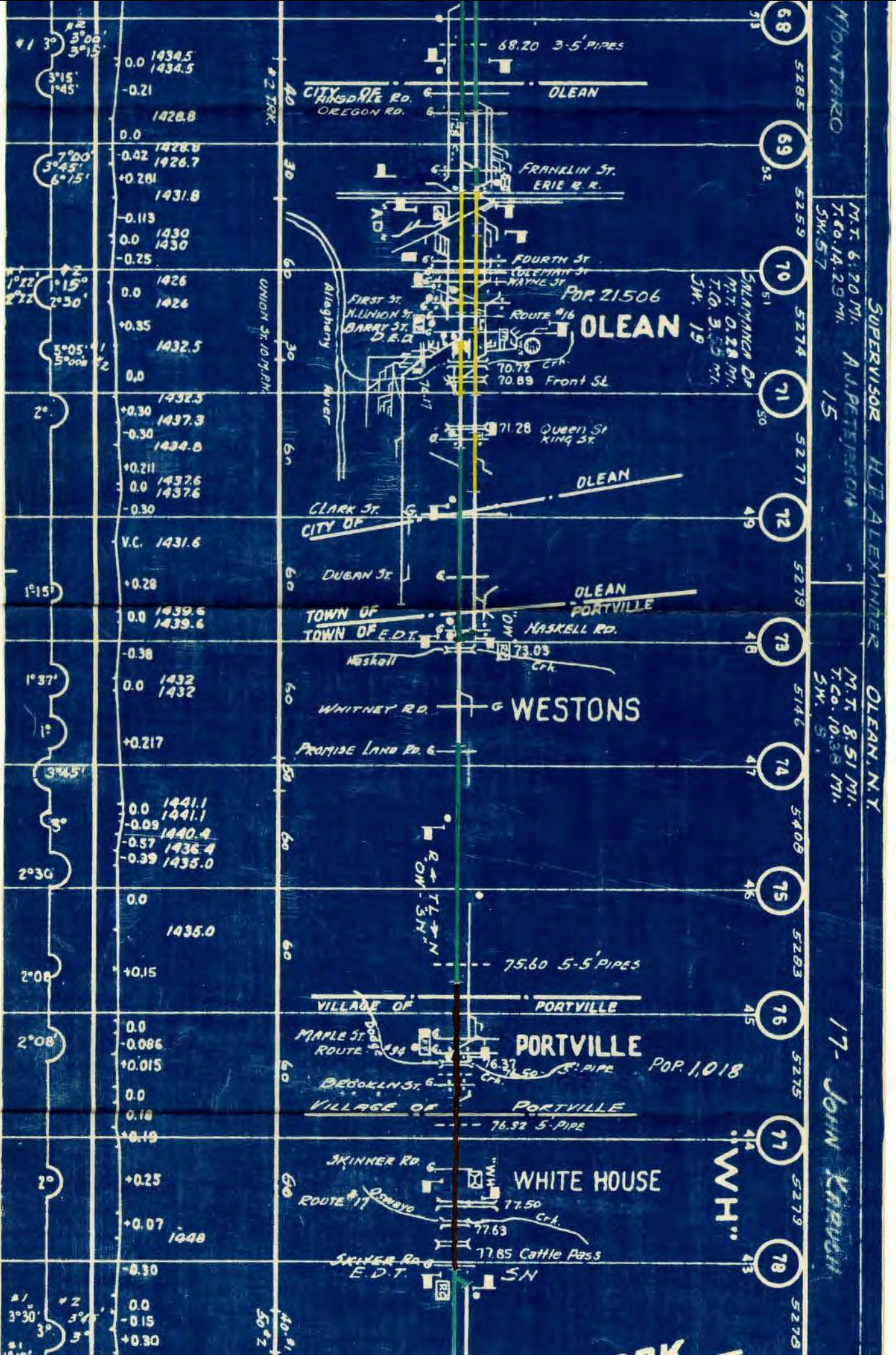

**SUPERVISOR** H. J. ALEXANDER  
**OLEAN, N.Y.**  
M.T. 6:20 MI. A. J. PETERSON  
T.CO. 14.29 MI. SW. 57  
15  
M.T. 8.51 MI.  
T.CO. 10.38 MI. SW. 51  
17- JOHN KROUCH



M.T. 9.38 MI.  
T.CO. 9.98 MI.  
5M. 2

18 - L. J. COLEMAN

M.T. 10.57 MI.  
T.CO. 13.25 MI.  
5M. 10

19 - P. A. BALDWIN

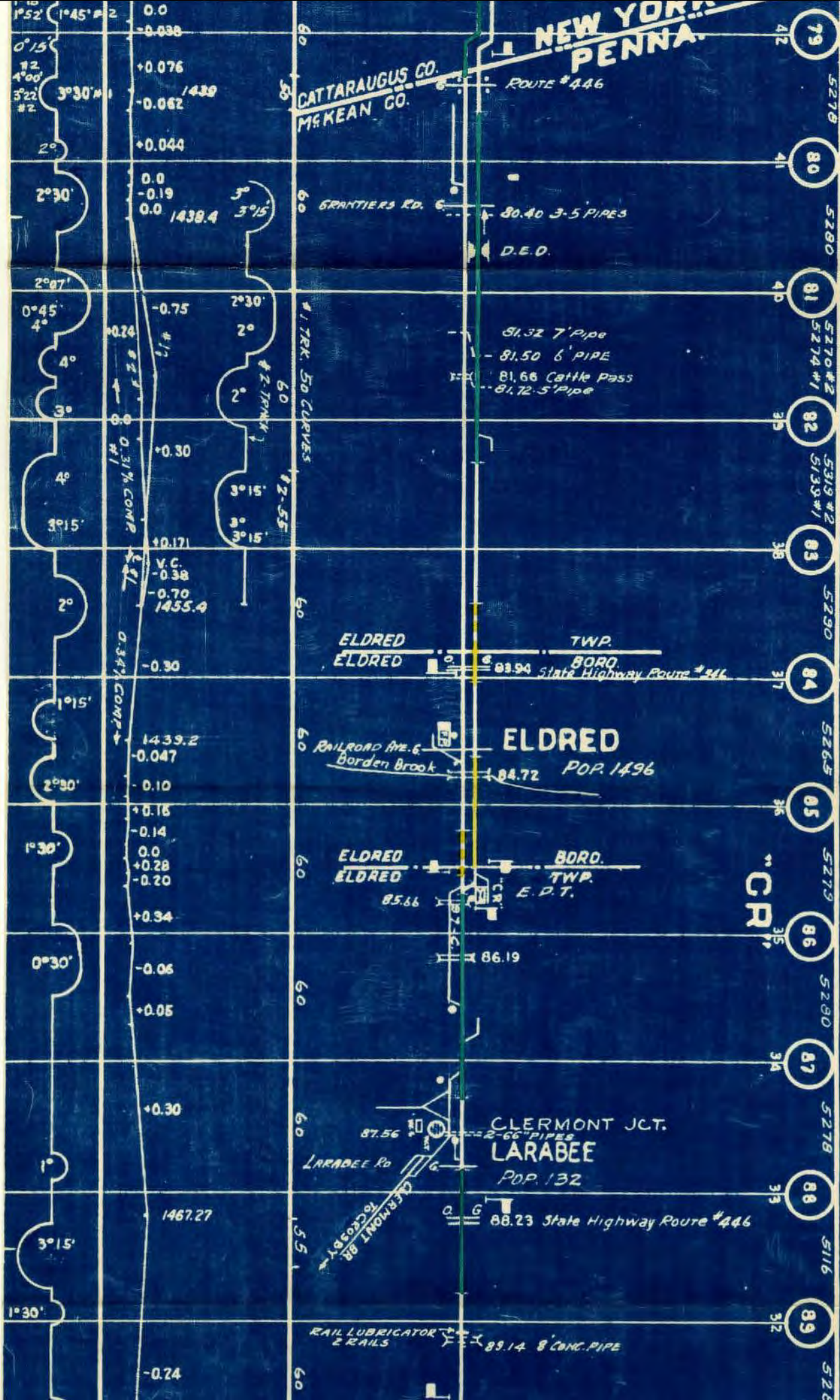



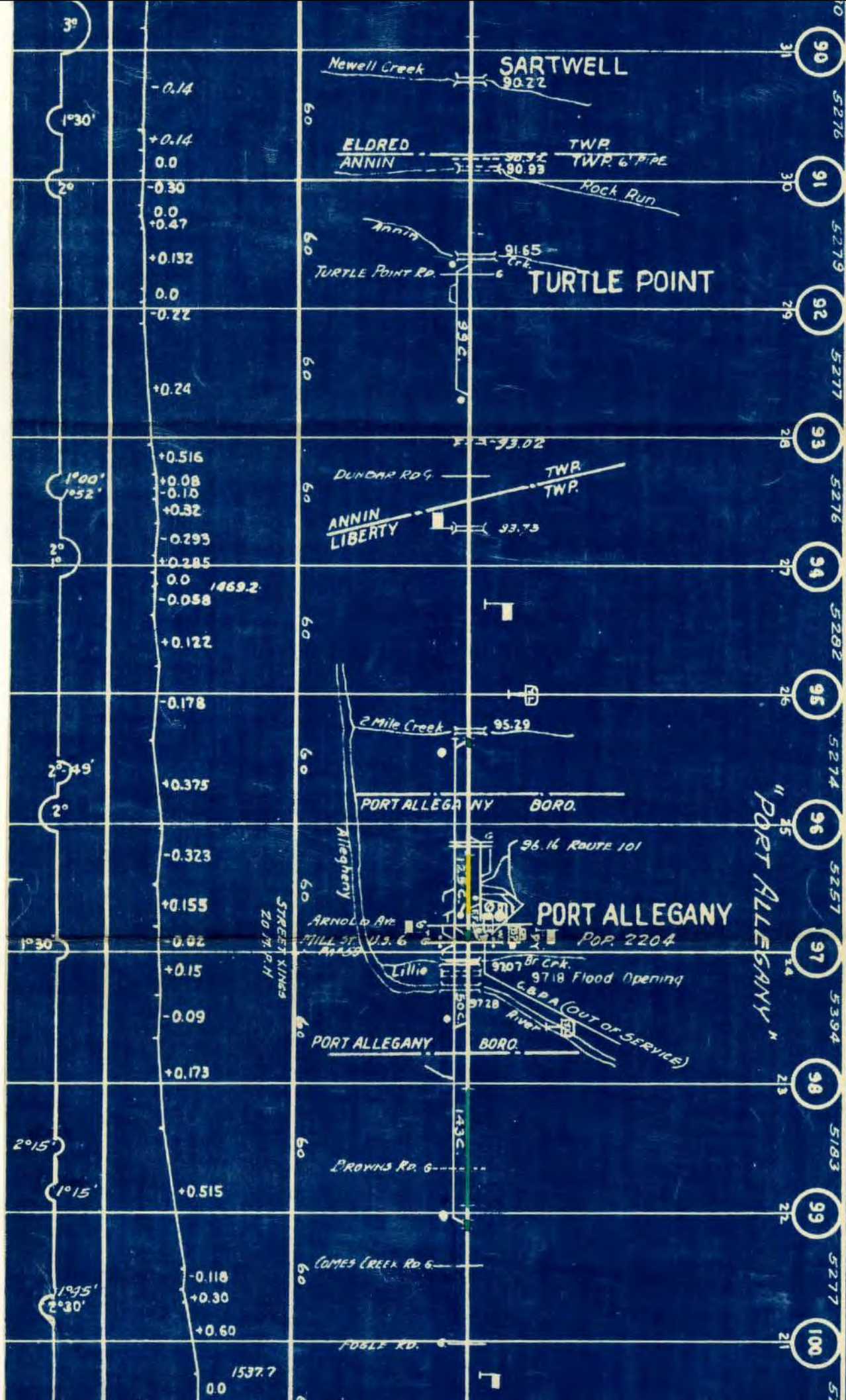



SUB DIVISION No. 3

M.T. 2.98 MI.  
T.C. 11.08 MI.  
SM. 6

218 H.P. PETERSON

M.T. 10.00 MI.  
T.C. 10.76 MI.  
SM. 8

228 GEO. BOTE

NR

KS

WRIGHTS

LIBERTY

McKEAN CO.  
POTTER CO.

KEATING SUMMIT

POTTER CO.  
McKEAN CO.

KEATING TWP.  
NORMICH TWP.

LIBERTY TWP.  
KEATING TWP.

LIBERTY TWP.  
ROAD #42470

Public Road

ROUTE #155

107.84 Austin Road

107.33

107.84

107.84

107.84

107.84

107.84

107.84

107.84

107.84

107.84

100.53

2.5' PIPES

0.0

+0.24

+0.48

+0.55

+0.82

+0.75

+0.475

+0.073

+0.67

+0.825

+0.54

+0.35

+0.83

+1.14

+0.75

+0.548

+0.33

+0.71

+0.35

0.0

+0.45

+1.0

+0.73

+0.175

+0.59

+1.48

+1.62

+1.58

+1.50

+1.82

+1.75

+1.05

+1.80

+1.35

+1.70

+1.60

+2.20

-2.30

-1.80

-2.20

-2.10

-2.20

1580.0

15972

1646.5

1666.5

1686.5

1706.5

1726.5

1746.5

1766.5

1786.5

1806.5

1826.5

1846.5

1866.5

1886.5

1906.5

1926.5

1946.5

1966.5

1986.5

2006.5

2026.5

2046.5

2066.5

2086.5

2106.5

2126.5

2146.5

2166.5

2186.5

2206.5

2226.5

2246.5

2266.5

2286.5

2306.5

2326.5

2346.5

2366.5

2386.5

2406.5

2426.5

2446.5

2466.5

1580.0

15972

1646.5

1666.5

1686.5

1706.5

1726.5

1746.5

1766.5

1786.5

1806.5

1826.5

1846.5

1866.5

1886.5

1906.5

1926.5

1946.5

1966.5

1986.5

2006.5

2026.5

2046.5

2066.5

2086.5

2106.5

2126.5

2146.5

2166.5

2186.5

2206.5

2226.5

2246.5

2266.5

2286.5

2306.5

2326.5

2346.5

2366.5

2386.5

2406.5

2426.5

2446.5

2466.5

1580.0

15972

1646.5

1666.5

1686.5

1706.5

1726.5

1746.5

1766.5

1786.5

1806.5

1826.5

1846.5

1866.5

1886.5

1906.5

1926.5

1946.5

1966.5

1986.5

2006.5

2026.5

2046.5

2066.5

2086.5

2106.5

2126.5

2146.5

2166.5

2186.5

2206.5

2226.5

2246.5

2266.5

2286.5

2306.5

2326.5

2346.5

2366.5

2386.5

2406.5

2426.5

2446.5

2466.5

1580.0

15972

1646.5

1666.5

1686.5

1706.5

1726.5

1746.5

1766.5

1786.5

1806.5

1826.5

1846.5

1866.5

1886.5

1906.5

1926.5

1946.5

1966.5

1986.5

2006.5

2026.5

2046.5

2066.5

2086.5

2106.5

2126.5

2146.5

2166.5

2186.5

2206.5

2226.5

2246.5

2266.5

2286.5

2306.5

2326.5

2346.5

2366.5

2386.5

2406.5

2426.5

2446.5

2466.5

1580.0

15972

1646.5

1666.5

1686.5

1706.5

1726.5

1746.5

1766.5

1786.5

1806.5

1826.5

1846.5

1866.5

1886.5

1906.5

1926.5

1946.5

1966.5

1986.5

2006.5

2026.5

2046.5

2066.5

2086.5

2106.5

2126.5

2146.5

2166.5

2186.5

2206.5

2226.5

2246.5

2266.5

2286.5

2306.5

2326.5

2346.5

2366.5

2386.5

2406.5

2426.5

2446.5

2466.5

1580.0

15972

1646.5

1666.5

1686.5

1706.5

1726.5

1746.5

1766.5

1786.5

1806.5

1826.5

1846.5

1866.5

1886.5

1906.5

1926.5

1946.5

1966.5

1986.5

2006.5

2026.5

2046.5

2066.5

2086.5

2106.5

2126.5

2146.5



SUB-DIVISION No 3

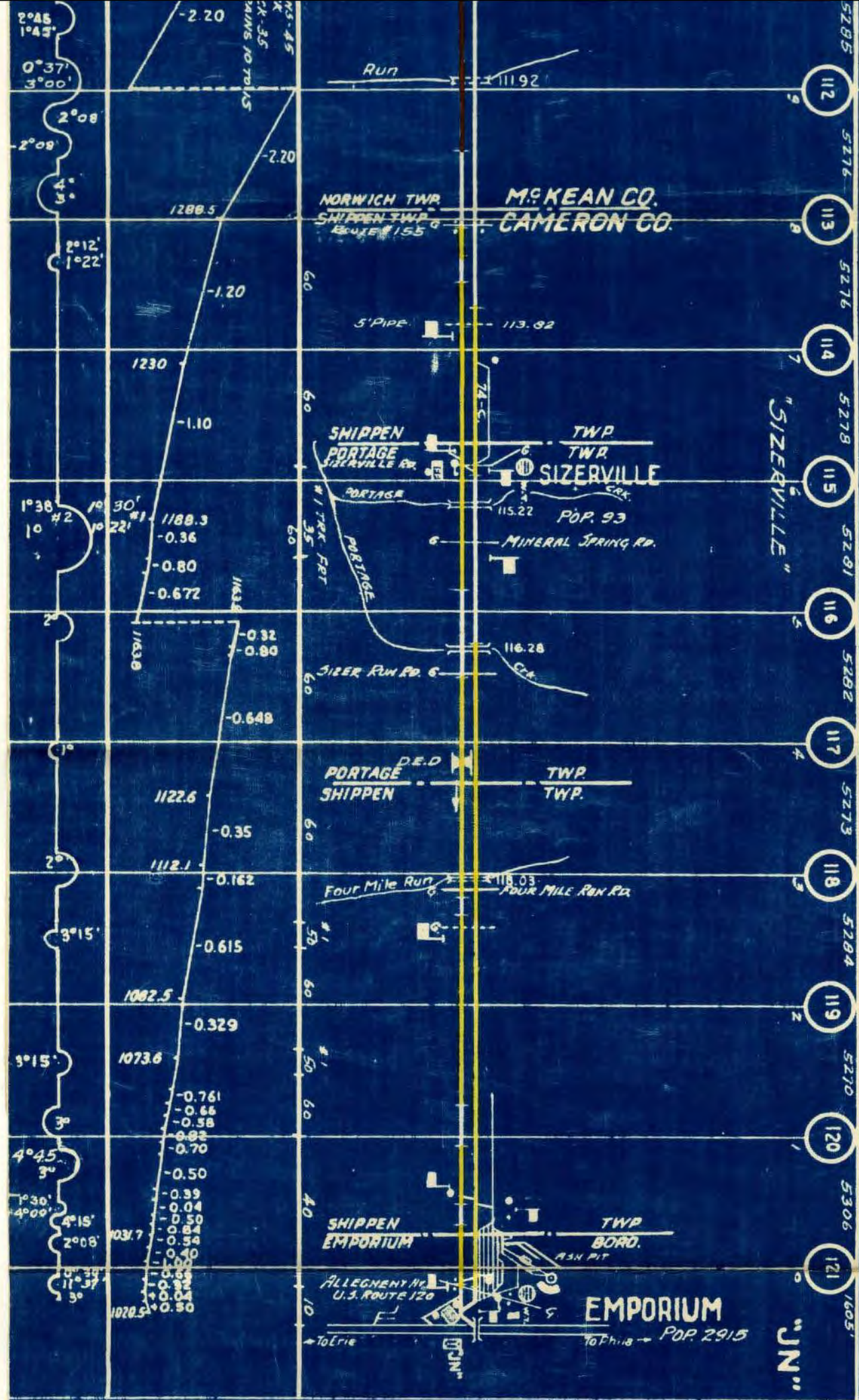



# -CHAUTAUQUA BRANCH-

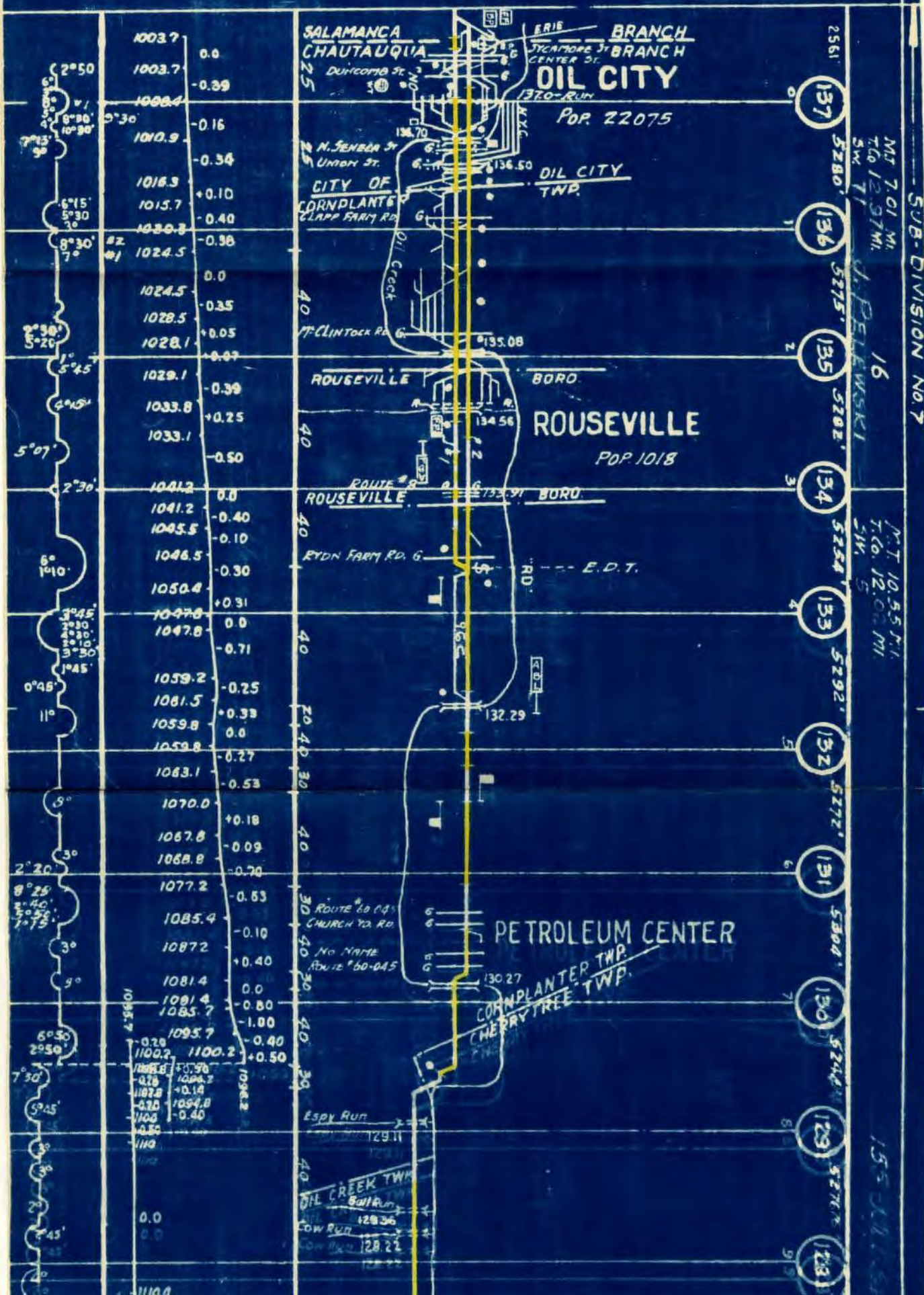



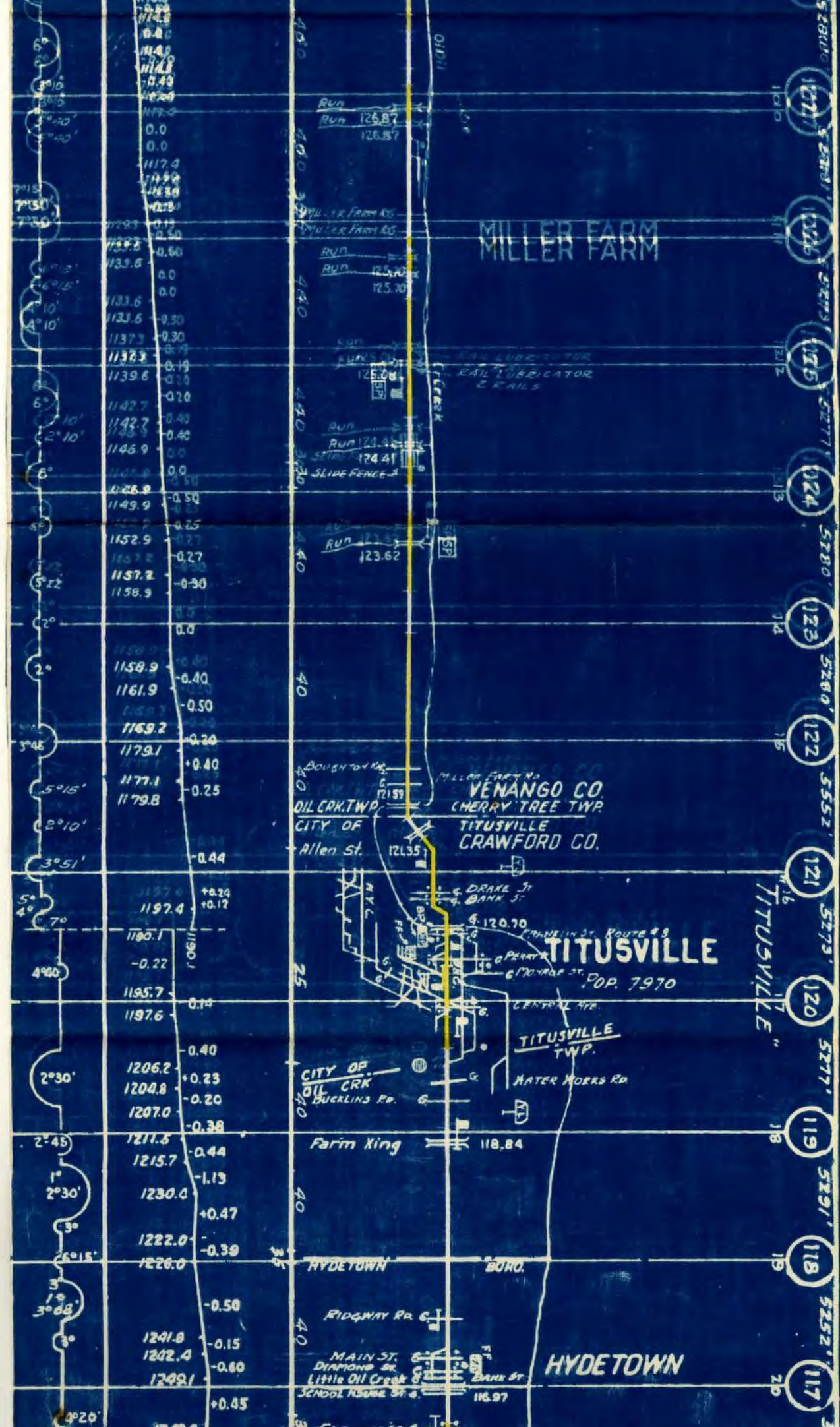







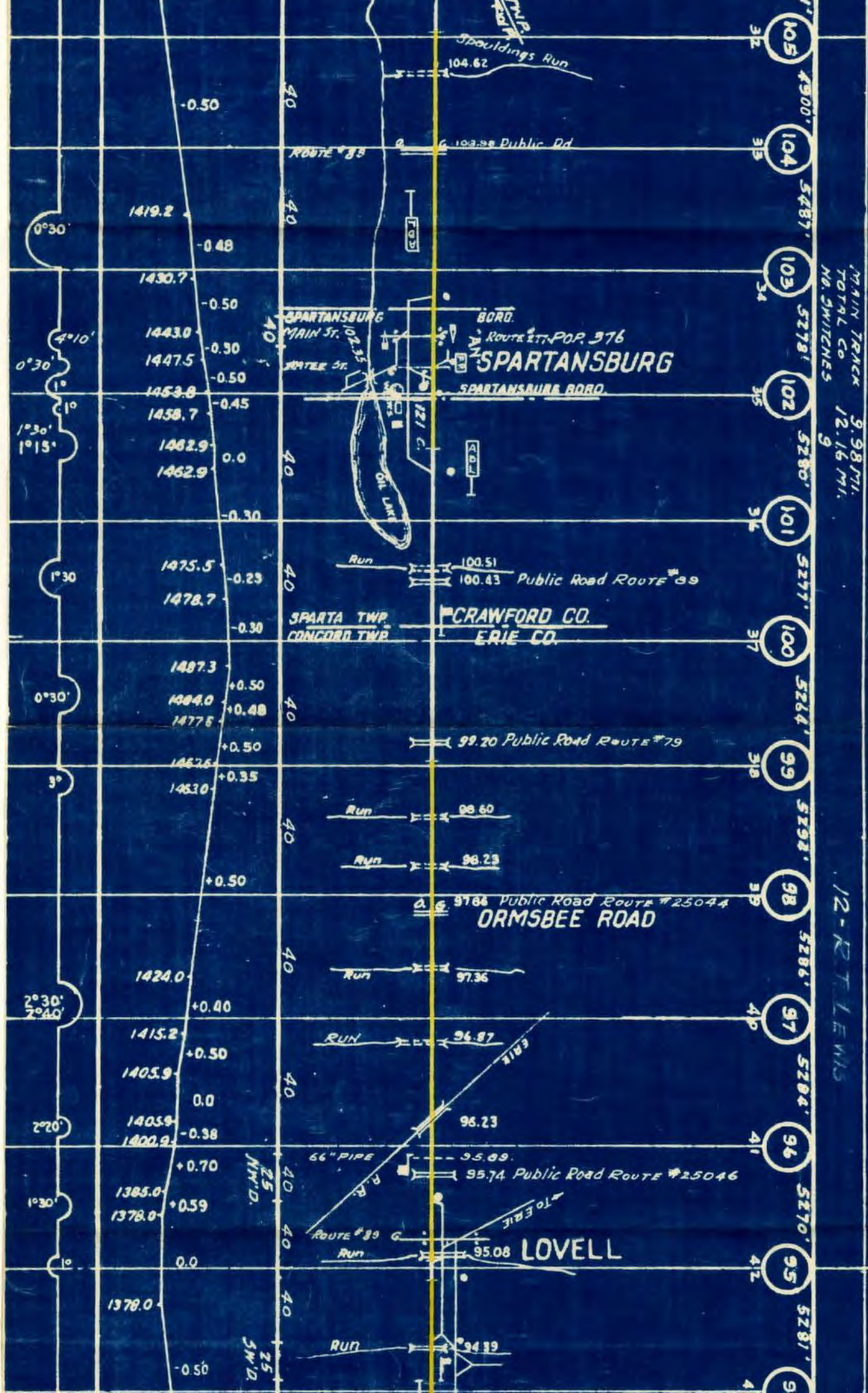

SUB DIVISION NO. 7

12 - RTLEWIS

MAIN TRACK 3.98 MI.  
TOTAL CO 12.16 MI.  
NO. SWITCHES 9

- 105 4900' 5487'
- 104 5487' 5278'
- 103 5278' 5280'
- 102 5280' 5277'
- 101 5277' 5264'
- 100 5264' 5292'
- 99 5292' 5286'
- 98 5286' 5284'
- 97 5284' 5270'
- 96 5270' 5281'
- 95 5281' 5281'



11 G. E. TANNER

M.T. 8.75 MI.  
T.C. 1.43 MI.  
M. 28

M.  
To  
No

"EY"

1400.0

1437.6

1439.5

1443.2

1429.4

1425.2

1422.4

1436.0

1442.0

1501.9

1501.9

1479.0

1467.2

1454.5

1437.5

1436.3

1440.8

1447.1

1448.6

1448.6

1451.8

1453.7

1463.5

1471.9

1469.5

1480.1

1484.6

1478.6

1477.4

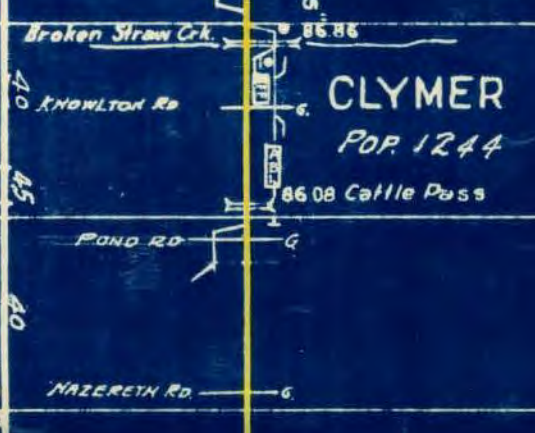
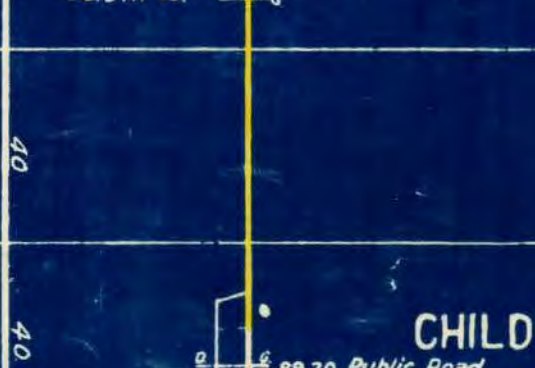
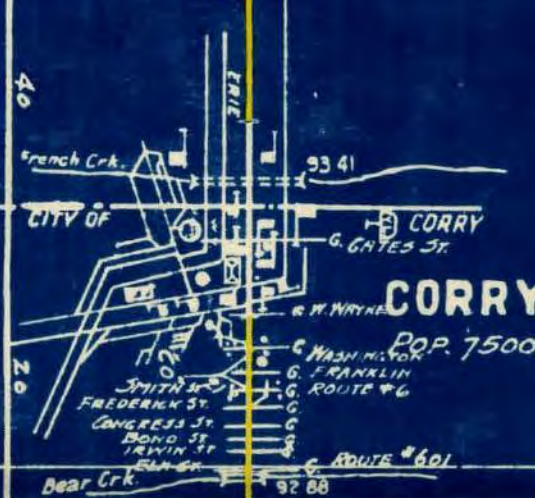

- 13639'
- 93
- 5278
- 92
- 5276
- 91
- 5294
- 90
- 5267
- 89
- 5290
- 88
- 5279
- 87
- 4935
- 86
- 5299
- 85
- 5179



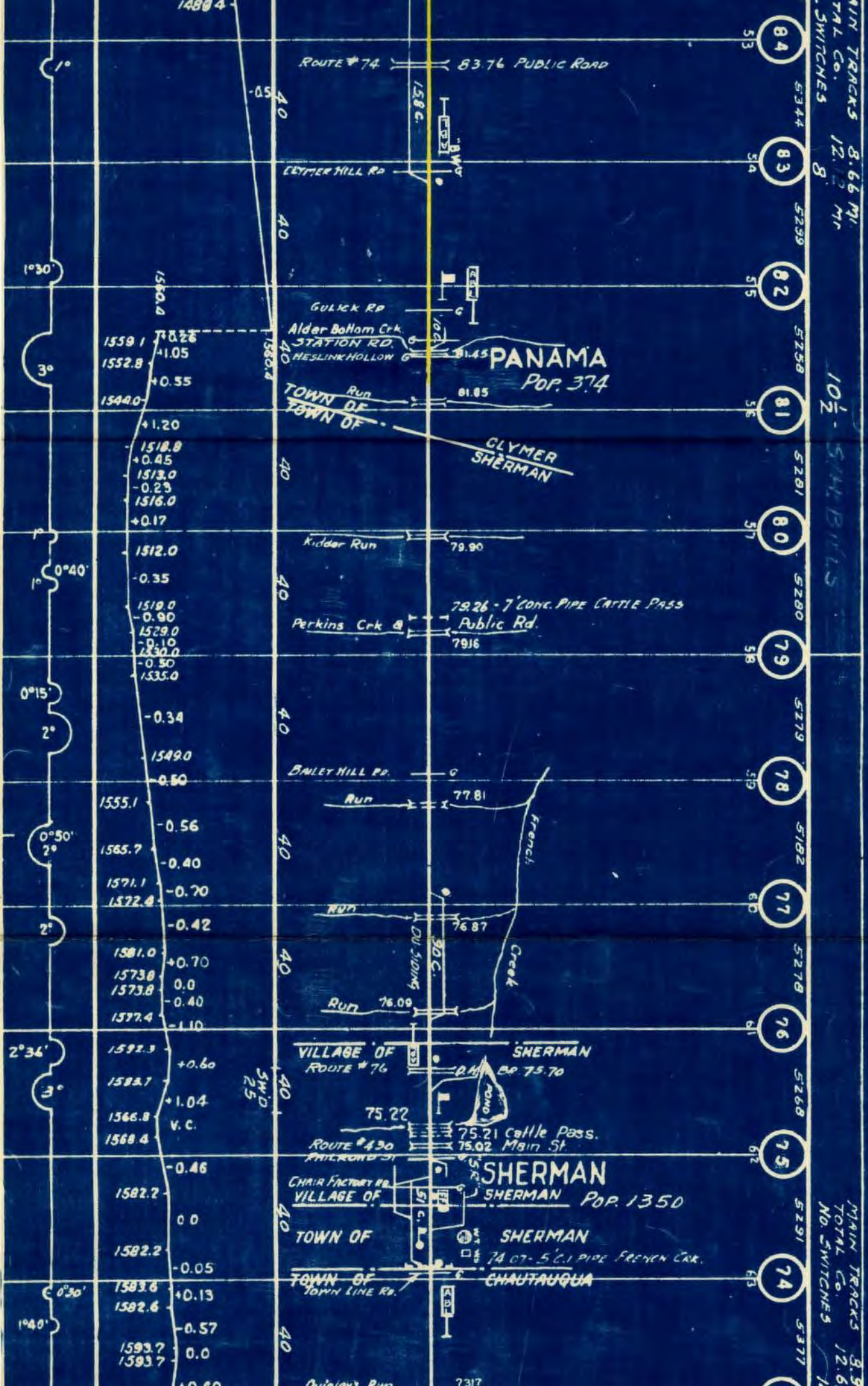

MAIN TRACKS 8.66 MI.  
TOTAL CO. 12.12 MI.  
SWITCHES 8  
10 1/2 - 544 BILLS  
MAIN TRACKS 8.5  
TOTAL CO. 12.6  
NO. SWITCHES 11



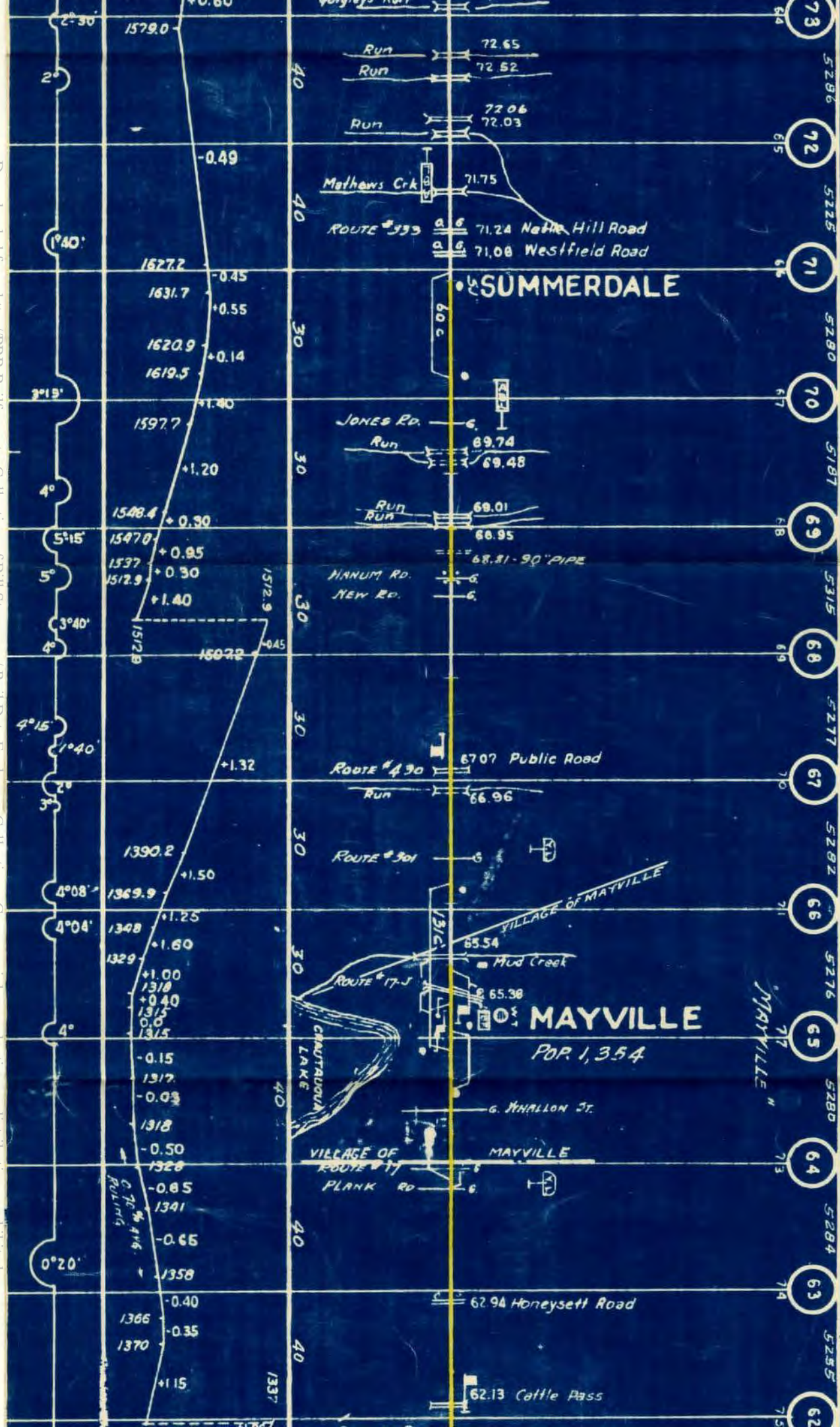











8.00 MI.  
5.25 MI.

5 A.A. BOTTIGELLO

MT. 8.00 MI.  
T.C. 10.01 MI.  
SW. 6

- 39 5281 98
- 38 5288 99
- 37 5253 100
- 36 5289 101
- 35 5290 102
- 34 5273 103
- 33 5276 104
- 32 5273 105
- 31 5312 106
- 30 5110 107
- 29 54 108

SHERIDAN

SILVER CREEK  
POP. 3067

CHAUTAUQUA CO.

ERIE CO.

IRVING





4 - C. PANZARELLA

MT. 7.98 MI.  
T. Co. 8.64 MI.  
SW. 5

3 - C. M. NIELTELLO

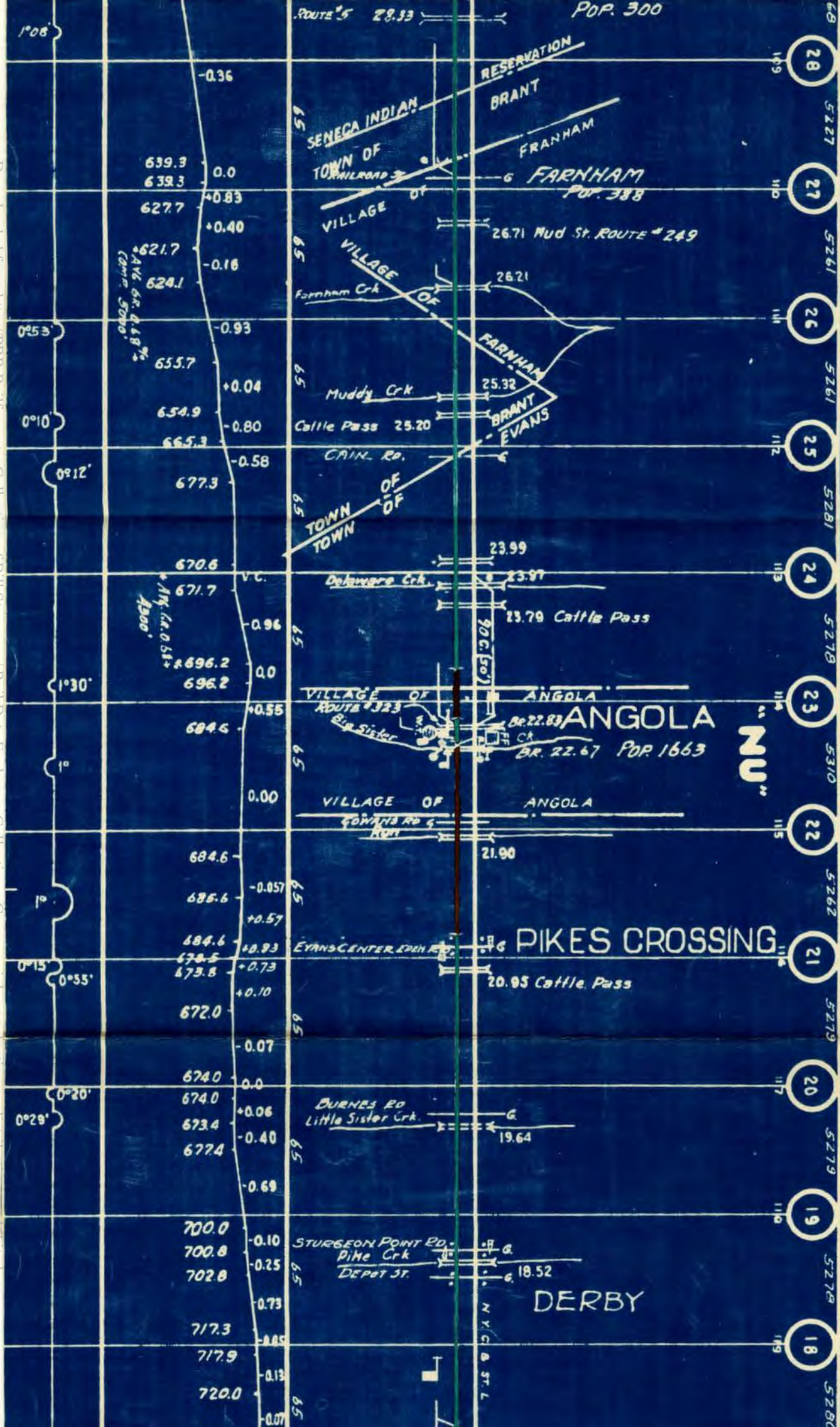



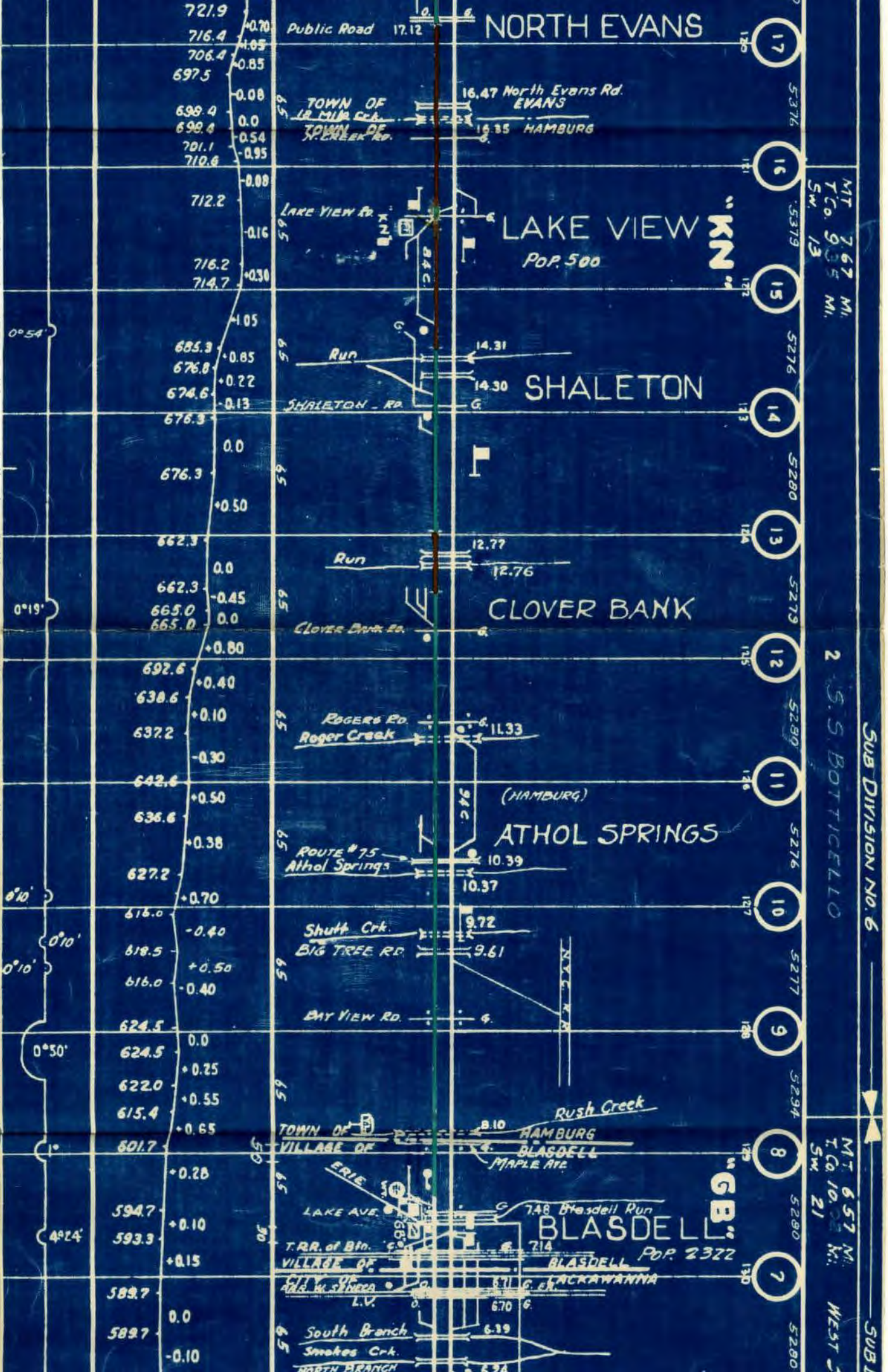



DIVISION NO. 1  
 SUPERVISOR J.M. RANKIN  
 BUFFALO, N.Y.  
 SUB-DIVISION NO. 1

MT. 0.90  
 T.O. 1.87  
 J.M. 0

E.B. BECKER

"FY"

"FW"

BUFFALO

POP. 615,000

POP. 24058

5.51 Ridge Rd.  
 LACKAWANNA  
 BUFFALO

6.5 B. Ry.  
 4.86  
 4.24  
 4.12 Tiffet St.

Buffalo Creek  
 Buffalo River  
 BUFFALO CREEK R.R.  
 2.94  
 2.82

2.63 SOUTH PARK AVE.  
 2.35 Elk St.  
 2.23

Seneca St.  
 Fillmore Ave.  
 Smith St.  
 Cord St.  
 Emelie St.

Seneca St.  
 Hamburg St.  
 Louisiana St.  
 Chicago St.  
 Michigan St.

MAX. SPEED

591.4  
 601.4  
 601.4  
 586.0  
 585.3  
 585.9  
 584.3  
 584.3  
 588.8  
 585.5  
 588.2  
 592.4  
 598.4  
 603.5  
 601.4  
 589.2  
 585.0  
 584.6

-0.33  
 0.0  
 +0.55  
 +0.06  
 0.0  
 0.05  
 0.0  
 -0.30  
 +0.20  
 -0.09  
 -0.30  
 -0.67  
 -0.43  
 +0.18  
 +0.76  
 +0.40  
 +0.05

0°22'  
 0°30'  
 0°22'

3°45'  
 2°15'

1°34'  
 12°34'

3°40'  
 10°

3°30'  
 2°40'  
 2°17'  
 2°36'  
 2°26'  
 2°47'  
 2°30'  
 1°40'  
 2°  
 2°41'  
 5°50'

+0.03  
 +0.15  
 +0.04

EAST SANDY

CONEMAUGH DIV.

118

119

# ALLEGHENY BRANCH PRR



SUB-DIVISION NO. 7

SUPERVISOR G.T. WEIDA OIL CITY, PA-ASST. SUPERVISOR

SUB-DIVISION

M.T. 8.00 MI.  
T.C. 28.28  
SW 35

18 J. S. BURDA

M.T. 7.21 MI.  
T.C. 15.00 MI.  
SW 35

NORTHERN DIV

ROCK

FRANKLIN  
POP. 10254

RIVER RIDGE

RIVER

"RH"

CRANBERRY TWP  
CITY OF OIL CITY

COUNTY

WYLLIS ST. G

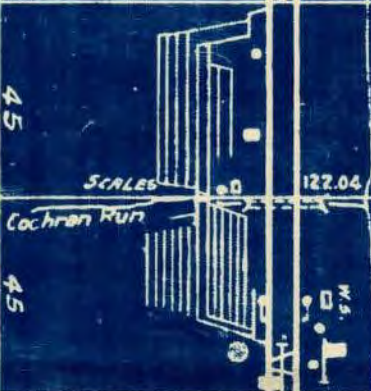

ROUTE 322  
123.73 Highway

124.56

TRACK 301-7

MAIN

E.D.T.

CURVES 31

4°20'  
1°20'  
3°10'

4°10'  
2°20'  
2°30'

3°  
4°50'  
4°10'  
3°  
1°45'

0°50'  
4°40'  
4°30'

1°30'  
0°45'  
1°20'  
1°00'  
0°50'  
1°20'

2°  
1°30'  
2°10'  
1°40'  
1°30'

0°40'  
1°50'

1°10'  
1°  
2°30'  
1°20'  
1°20'  
0°30'

0°30'  
1°  
1°50'

4°30'  
4°20'

2°30'  
1°45'

1°20'  
4°  
4°20'

2°40'  
3°15'



